



HESTORE.HU

elektronikai alkatrész áruház

EN: This Datasheet is presented by the manufacturer.

Please visit our website for pricing and availability at www.hestore.hu.

■Features

- High Power LEDs
- 10mm Standard Directivity
- Superior Weather-resistance
- UV Resistant Epoxy

■Applications

- Automotive Dashboard Lighting
- Back Lighting

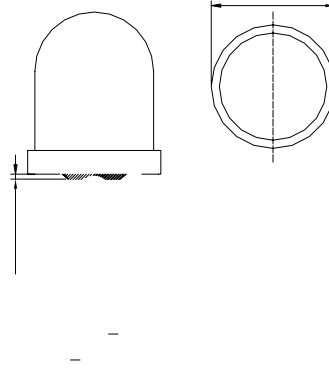
■Outline Dimension

Operating Temperature	Topr	-30~ +80	60
-----------------------	------	----------	----

■Electrical -Optical Characteristics (Ta=25R)

		=5V	-	-	10	μA
Dom. Wavelength	λ_d	$I_F=20mA$	465	470	475	nm
Luminous Intensity	I_v	$I_F=20mA$	1560	2180	3000	mcd
50% Power Angle	$2\theta_{1/2}$	$I_F=20mA$	-	30	-	deg

LED & Application Technologies