



HESTORE.HU

elektronikai alkatrész áruház

EN: This Datasheet is presented by the manufacturer.

Please visit our website for pricing and availability at www.hestore.hu.



Mittlerer Kippschalter der Serie KN3

Ningbo Jietong Electronic Co., Ltd.
No.16 Huapu Road, 315803 Ningbo, China

Importeur: Transfer Multisort Elektronik Sp. z o.o., ul. Ustronna 41, 93-350 Łódź, Polska



Bestellinformationen

KN3 (C) - 102APE-B2

- Typenschild
- Typenschildoptionen
- Griffoptionen
- Terminaloptionen
- Nenleistung
- Schaltungseigenschaft
- Stangen
- Kippschalter Typ "C"

Spezifikation

1. Nenleistung: () 10A 125VAC; 6A 250VAC
(A) 15A 125VAC; 10A 250VAC
(AA) 20A 125VAC; 15A 250VAC
2. Kontaktwiderstand: 50 mΩ max
3. Isolationswiderstand: 500 VDC 1000 MΩ min
4. Durchschlagfestigkeit: 1500 VAC, 1 Minute
5. Betriebstemperatur: -25°C ~ +85°C
6. Elektrisches Leben: 10,000 Zyklen

Schaltungseigenschaft

01	ON	-	OFF
02	ON	-	ON
12	ON	-	(ON)
03	ON	OFF	ON
13	ON	OFF	(ON)
23	(ON)	OFF	(ON)

() : zeigt momentan an

Terminaloptionen

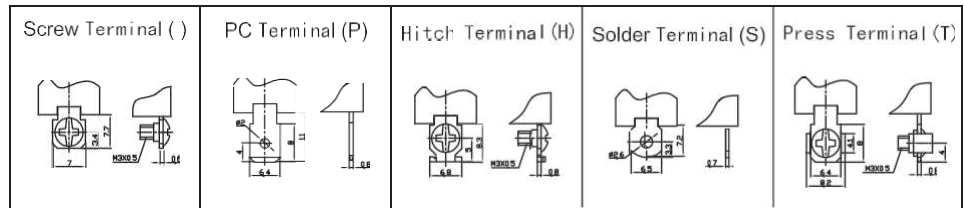

Griffoptionen

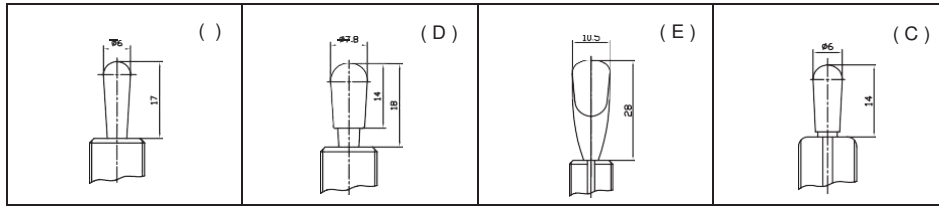

Spezielle Basis

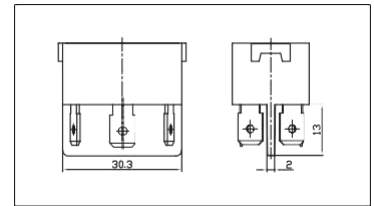

Typenschildoptionen

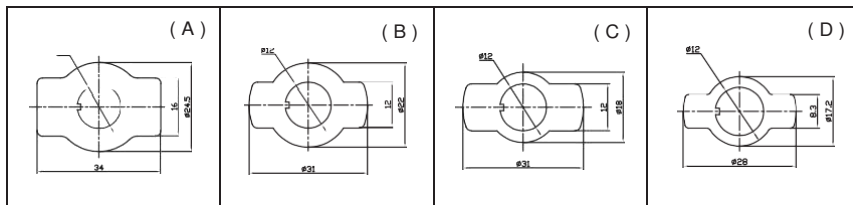

Typenschild Markierung

1	ON - OFF
2	ON - ON
3	ON - OFF - ON

Basisfarbe

Material	Basisfarbe	
Bakelit	Schwarz	Braun
PC	Rot	
Melamin	Blau	

Wasserdichte Schutz



KN3(C)-101 ON-OFF
KN3(C)-101A ON-OFF
SPST 2P

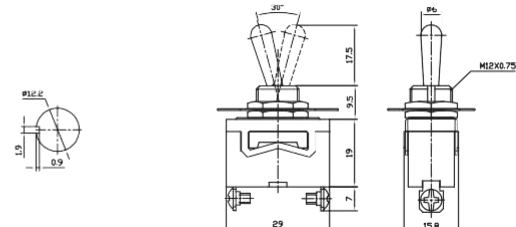



Mittlerer Kippschalter der Serie KN3



KN3(C)-102 KN3(C)-102A ON-ON KN3(C)-112 KN3(C)-112A ON-(ON) KN3(C)-103 KN3(C)-103A ON-OFF-ON KN3(C)-113 KN3(C)-113A ON-OFF-(ON) KN3(C)-123 KN3(C)-123A (ON)-OFF-(ON) SPDT 3P

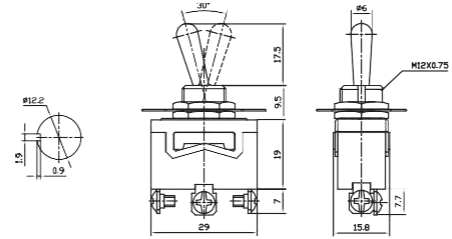

KN3(C)-201 ON-OFF
KN3(C)-201A ON-OFF
DPST 4P

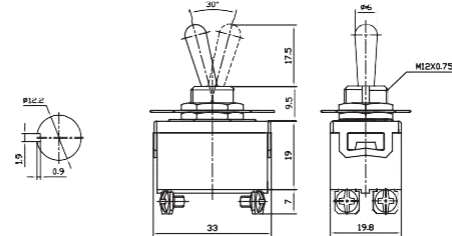

KN3(C)-202 KN3(C)-202A ON-ON KN3(C)-212 KN3(C)-212A ON-(ON) KN3(C)-203 KN3(C)-203A ON-OFF-ON KN3(C)-213 KN3(C)-213A ON-OFF-(ON) KN3(C)-223 KN3(C)-223A (ON)-OFF-(ON) DPDT 6P

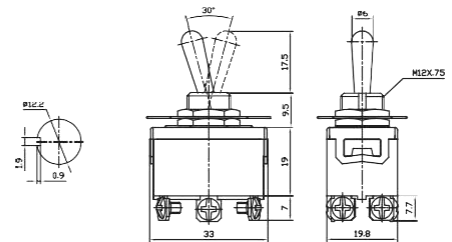

KN3(C)-101P ON-OFF
KN3(C)-101AP ON-OFF
SPST 2P

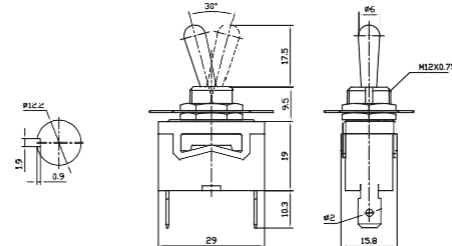

KN3(C)-102P KN3(C)-102AP ON-ON KN3(C)-112P KN3(C)-112AP ON-(ON) KN3(C)-103P KN3(C)-103AP ON-OFF-ON KN3(C)-113P KN3(C)-113AP ON-OFF-(ON) KN3(C)-123P KN3(C)-123AP (ON)-OFF-(ON) SPDT 3P

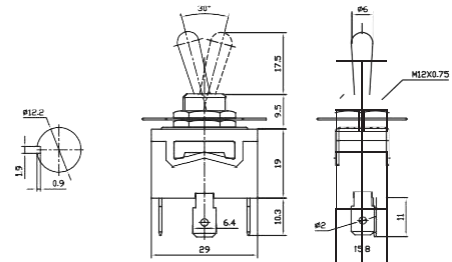

KN3(C)-201P ON-OFF
KN3(C)-201AP ON-OFF
DPST 4P

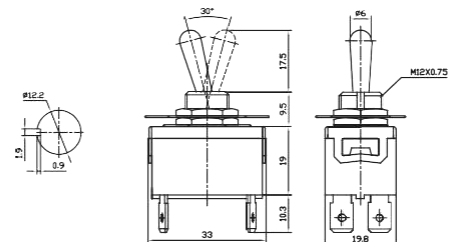

KN3(C)-202P KN3(C)-202AP ON-ON KN3(C)-212P KN3(C)-212AP ON-(ON) KN3(C)-203P KN3(C)-203AP ON-OFF-ON KN3(C)-213P KN3(C)-213AP ON-OFF-(ON) KN3(C)-223P KN3(C)-223AP (ON)-OFF-(ON) DPDT 6P

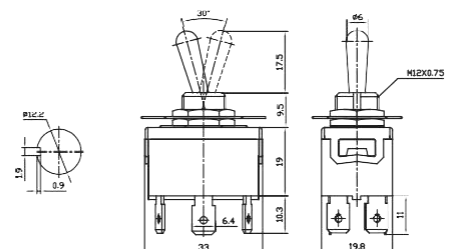



Mittlerer Kippschalter der Serie KN3

	<p> KN3(C)-102AE ON-ON KN3(C)-112AE ON-(ON) KN3(C)-103AE ON-OFF-ON KN3(C)-113AE ON-OFF-(ON) KN3(C)-123AE (ON)-OFF-(ON) SPDT 3P </p>	
	<p> KN3(C)-202AE ON-ON KN3(C)-212AE ON-(ON) KN3(C)-203AE ON-OFF-ON KN3(C)-213AE ON-OFF-(ON) KN3(C)-223AE (ON)-OFF-(ON) DPDT 6P </p>	
	<p> KN3(A)-101 ON-OFF KN3(A)-101A ON-OFF SPST 2P UL Nenleistung: 20A 125VAC; 10A 250VAC; 3/4HP 125/250VAC </p>	
	<p> KN3(A)-102 KN3(A)-102A ON-ON KN3(A)-112 KN3(A)-112A ON-(ON) KN3(A)-103 KN3(A)-103A ON-OFF-ON KN3(A)-113 KN3(A)-113A ON-OFF-(ON) KN3(A)-123 KN3(A)-123A (ON)-OFF-(ON) SPDT 3P UL Nenleistung: 20A 125VAC; 10A 250VAC; 3/4HP 125/250VAC </p>	
	<p> KN3(A)-101P ON-OFF KN3(A)-101AP ON-OFF SPST 2P UL Nenleistung: 20A 125VAC; 10A 250VAC; 3/4HP 125/250VAC </p>	
	<p> KN3(A)-102P KN3(A)-102AP ON-ON KN3(A)-112P KN3(A)-112AP ON-(ON) KN3(A)-103P KN3(A)-103AP ON-OFF-ON KN3(A)-113P KN3(A)-113AP ON-OFF-(ON) KN3(A)-123P KN3(A)-123AP (ON)-OFF-(ON) SPDT 3P UL Nenleistung: 20A 125VAC; 10A 250VAC; 3/4HP 125/250VAC </p>	
	<p> KN3(B)-101 ON-OFF KN3(B)-101A ON-OFF SPST 2P </p>	



Mittlerer Kippschalter der Serie KN3



KN3(B)-102 KN3(B)-102A ON-ON
KN3(B)-112 KN3(B)-112A ON-(ON)
KN3(B)-103 KN3(B)-103A ON-OFF-ON
KN3(B)-113 KN3(B)-113A ON-OFF-(ON)
KN3(B)-123 KN3(B)-123A (ON)-OFF-(ON)
 SPDT 3P

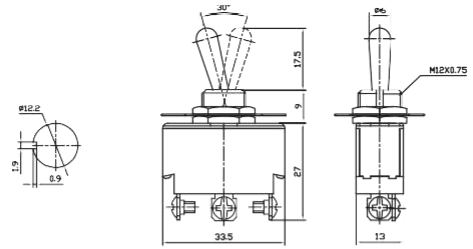

KN3(B)-201 ON-OFF
KN3(B)-201A ON-OFF
 DPST 4P
 UL Nenleistung: 20A 125VAC; 10A 250VAC; 1-1/2HP 125/250VAC

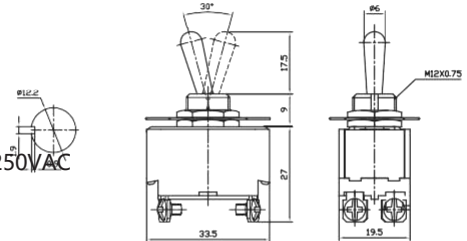

KN3(B)-202 KN3(B)-202A ON-ON **KN3(B)-212**
KN3(B)-212A ON-(ON) **KN3(B)-203**
KN3(B)-203A ON-OFF-ON **KN3(B)-213**
KN3(B)-213A ON-OFF-(ON)
KN3(B)-223 KN3(B)-223A (ON)-OFF-(ON)
 DPDT 6P
 UL Nenleistung: 20A 125VAC; 10A 250VAC; 1-1/2HP 125/250VAC

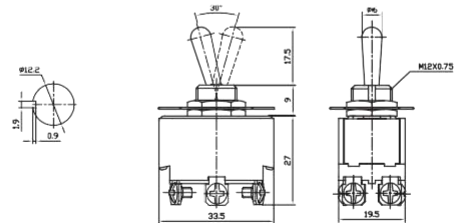

KN3(B)-201P ON-OFF
KN3(B)-201AP ON-OFF
 DPST 4P
 UL Nenleistung: 20A 125VAC; 10A 250VAC; 1-1/2HP 125/250VAC

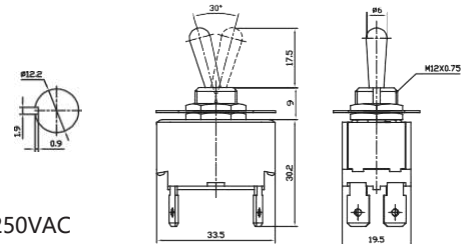

KN3(B)-202P KN3(B)-202AP ON-ON **KN3(B)-212P**
KN3(B)-212AP ON-(ON) **KN3(B)-203P**
KN3(B)-203AP ON-OFF-ON **KN3(B)-213P**
KN3(B)-213AP ON-OFF-(ON) **KN3(B)-223P**
KN3(B)-223AP (ON)-OFF-(ON) DPDT 6P
 UL Nenleistung: 20A 125VAC; 10A 250VAC; 1-1/2HP 125/250VAC

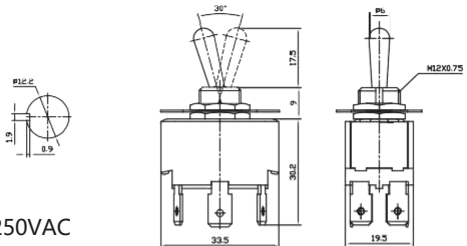

KN3(B)-402 ON-ON
KN3(B)-402A ON-ON
KN3(B)-403 ON-OFF-ON
KN3(B)-403A ON-OFF-ON
 4PDT 12P

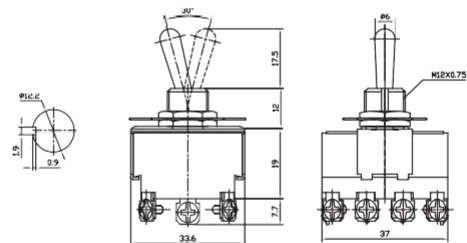

KN3(B)-102AE ON-ON
KN3(B)-112AE ON-(ON)
KN3(B)-103AE ON-OFF-ON
KN3(B)-113AE ON-OFF-(ON)
KN3(B)-123AE (ON)-OFF-(ON)
 SPDT 3P

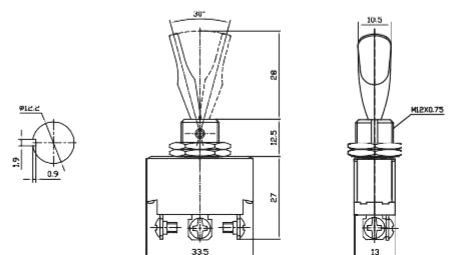



Mittlerer Kippschalter der Serie KN3



KN3(B)-202AE ON-ON
KN3(B)-212AE ON-(ON)
KN3(B)-203AE ON-OFF-ON
KN3(B)-213AE ON-OFF-(ON)
KN3(B)-223AE (ON)-OFF-(ON)
 DPDT 6P

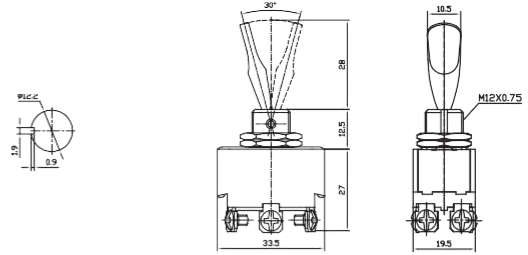

KN3(D)-101 ON-OFF
KN3(D)-111 (ON)-OFF
 6A 125VAC; 3A 250VAC; 25A 12VDC
 SPST 2P

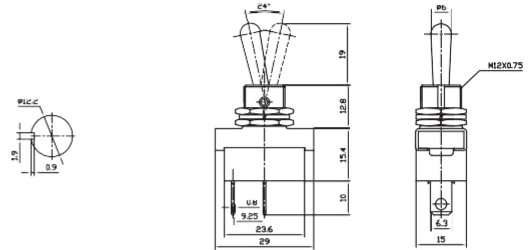

KN3(D)-102 ON-ON
KN3(D)-103 ON-OFF-ON
KN3(D)-123 (ON)-OFF-(ON)
 6A 125VAC; 3A 250VAC; 25A 12VDC
 SPDT 3P

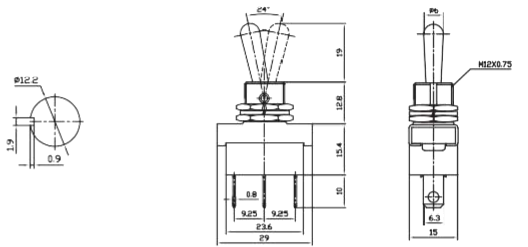

KN3(D)-202 ON-ON
 DPDT 6P
 10A 125VAC; 5A 250VAC

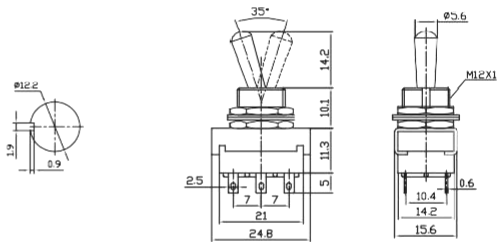

KN3(E)-101 ON-OFF
 6A 125VAC; 3A 250VAC
 SPST 2P
 (PL ASTIC CAP)

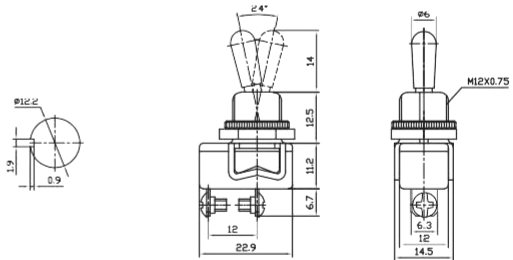

KN3(E)-101P ON-OFF
 6A 125VAC; 3A 250VAC
 SPST 2P
 (PL ASTIC CAP)

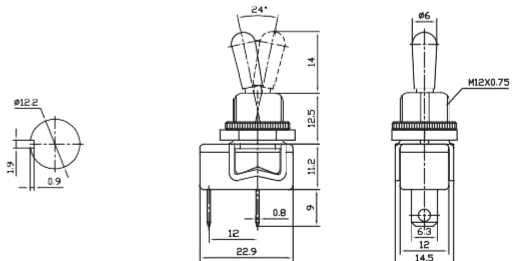

KN3(E)-101MP ON-OFF
 6A 125VAC; 3A 250VAC SPST
 2P
 (METAL LEVER)

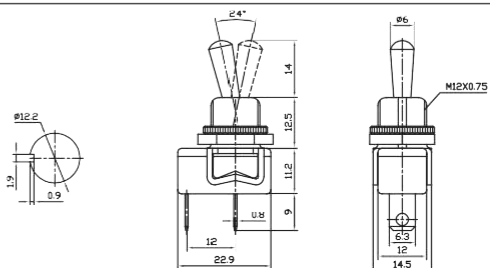



Mittlerer Kippschalter der Serie KN3

KN3-1 ON-OFF

4A 125VAC; 2A 250VAC

SPST 2P

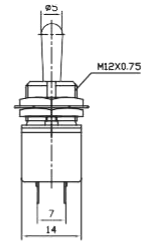
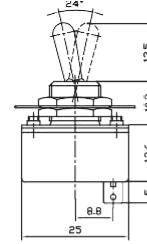

KN3-2 ON-OFF

4A 125VAC; 2A 250VAC

SPDT 4P

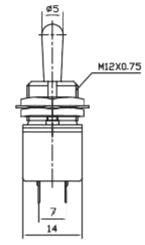
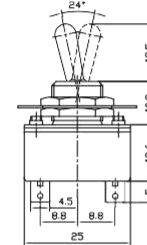

KN3-3 ON-ON

5A 125VAC; 3A 250VAC

DPDT 6P

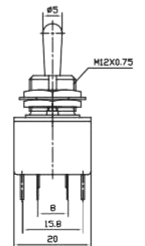
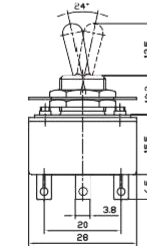

KNS-1 ON-OFF

6A 125VAC; 3A 250VAC; 10A 12VDC

SPST 2P

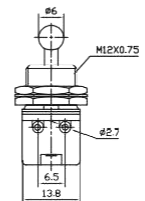
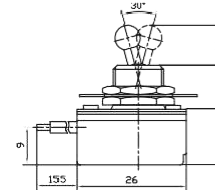

KNS-2 ON-OFF

6A 125VAC; 3A 250VAC; 10A 12VDC

SPST 2P

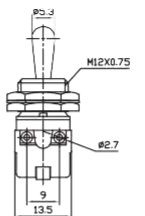
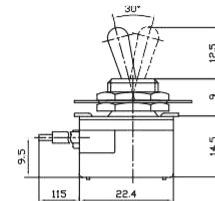

KNH-1 ON-OFF

6A 125VAC; 3A 250VAC; 10A 12VDC

SPST 2P

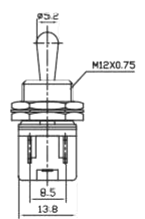
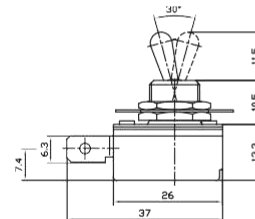

KNH-1S ON-OFF

6A 125VAC; 3A 250VAC; 10A 12VDC

SPST 2P (mit der Schraube)

