



HESTORE.HU

elektronikai alkatrész áruház

EN: This Datasheet is presented by the manufacturer.

Please visit our website for pricing and availability at www.hestore.hu.



PRESSACAVI

CABLE-GLANDS



PRESSACAVI CERTIFICATI PER INSTALLAZIONI ELETTRICHE CERTIFIED CABLE GLANDS FOR ELECTRICAL INSTALLATIONS

Lamelle di tenuta che permettono un serraggio progressivo senza scatti e una notevole resistenza alla trazione/torsione del cavo.

Sealing slots that allow for smooth progressive clamping and provide remarkable resistance to the cable's traction and twist.

Corpo pressacavo con filettatura ideata per assicurare un'eccellente tenuta meccanica e impedire svitamenti accidentali.

Cable gland with a thread design engineered to ensure excellent mechanical sealing and prevent accidental unscrewing.

PRESSACAVO CON FLANGIA PASSO PG IP68

*CABLE GLAND WITH FLANGE
PG THREAD IP68*

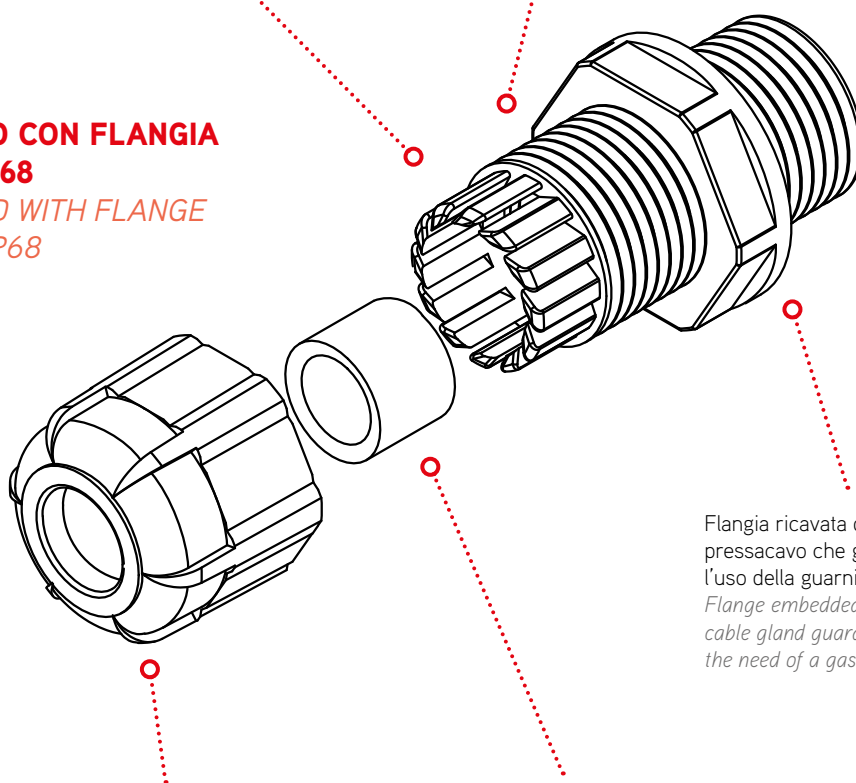

Flangia ricavata direttamente sul corpo del pressacavo che garantisce la tenuta IP68 senza l'uso della guarnizione.

Flange embedded directly on the body of the cable gland guaranteeing IP68 sealing without the need of a gasket.

Testina con esagono rinforzato che permette un facile e sicuro avvvitamento.

Pressure-screw with strengthened hexagon that allows easy and secure screwing.

Guarnizione interna in gomma nitrilica che garantisce una perfetta tenuta IP68 sul cavo.

Nitrile rubber inner gasket that guarantees perfect IP68 sealing on the cable.



file n° E171361



file n° E171361



LR 44081-10

IP68

Vai a pagina 192 per avere tutte le informazioni di questo prodotto.

Find detailed information about this product on page 192.

PRESSACAVI: CORRETTA INSTALLAZIONE

CABLE GLANDS: CORRECT INSTALLATION

DIAMETRO DEL FILETTO · DIAMETRO FORO DI INSTALLAZIONE

THREAD DIAMETER · INSTALLATION HOLE DIAMETER

FILETTO METRICO EN 60423 · METRIC THREAD EN 60423

| | | M 12x1,5 | M 16x1,5 | M 20x1,5 | M 25x1,5 | M 32x1,5 | M 40x1,5 | M 50x1,5 | M 63x1,5 |
|----------------------------------|----|----------|----------|----------|----------|----------|----------|----------|----------|
| Diametro filetto Thread diam. | mm | 12 | 16 | 20 | 25 | 32 | 40 | 50 | 63 |
| Diametro foro Hole diameter | mm | 12,5 | 16,5 | 20,5 | 25,5 | 32,5 | 40,5 | 50,5 | 63,5 |

FILETTO PG DIN 40430 · PG THREAD DIN 40430

| | | PG 7 | PG 9 | PG 11 | PG 13,5 | PG 16 | PG 21 | PG 29 | PG 36 | PG 42 | PG 48 |
|----------------------------------|----|------|------|-------|---------|-------|-------|-------|-------|-------|-------|
| Diametro filetto Thread diam. | mm | 12,5 | 15,2 | 18,6 | 20,4 | 22,5 | 28,3 | 37 | 47 | 54 | 59,3 |
| Diametro foro Hole diameter | mm | 13 | 15,5 | 19 | 21 | 23 | 28,5 | 37,5 | 47,5 | 54,5 | 60 |

FILETTO GAS ISO 228/1 · GAS THREAD ISO 228/1

| | | GAS | | | | | GAS 1 | | | GAS 2 | | GAS 3 | |
|----------------------------------|----|------|------|------|------|------|-------|------|------|-------|-------|-------|-------|
| | | 1/4 | 3/8 | 1/2 | 5/8 | 3/4 | GAS 1 | 1/8 | 1/4 | 1/2 | GAS 2 | 1/2 | GAS 3 |
| Diametro filetto Thread diam. | mm | 13,2 | 16,7 | 21 | 22,9 | 26,4 | 33,3 | 37,9 | 41,9 | 47,8 | 59,6 | 75,2 | 87,9 |
| Diametro foro Hole diameter | mm | 13,5 | 17 | 21,5 | 23,5 | 27 | 33,5 | 38,5 | 42,5 | 48 | 60 | 75,5 | 88,5 |

VALORE MINIMO DI COPPIA DI SERRAGGIO PER GARANTIRE LA PROTEZIONE IP68

MINIMUM TORQUE VALUE TO GUARANTEE IP68 PROTECTION

FILETTO METRICO EN 60423 · METRIC THREAD EN 60423

| | | M 12x1,5 | M 16x1,5 | M 20x1,5 | M 25x1,5 | M 32x1,5 | M 40x1,5 | M 50x1,5 | M 63x1,5 |
|------------------------------------|----------------------|----------|----------|----------|----------|----------|----------|----------|----------|
| Coppia di serraggio Head torque | newton metro (Nm) | 2 | 2,5 | 5 | 6 | 7 | 10 | 11,5 | 12,5 |

FILETTO PG DIN 40430 · PG THREAD DIN 40430

| | | PG 7 | PG 9 | PG 11 | PG 13,5 | PG 16 | PG 21 | PG 29 | PG 36 | PG 42 | PG 48 |
|------------------------------------|----------------------|------|------|-------|---------|-------|-------|-------|-------|-------|-------|
| Coppia di serraggio Head torque | newton metro (Nm) | 2,5 | 3,75 | 3,75 | 5 | 6 | 7 | 10 | 11,5 | 12,5 | 12,5 |

PRESSACAVI IN NYLON · NYLON CABLE GLANDS

CAPACITÀ DI SERRAGGIO · CLAMPING RANGE

CAPACITÀ DI SERRAGGIO FILETTO METRICO IP68 · METRIC THREAD IP68 CLAMPING RANGE

| Passo | 3 | 4 | 5 | 6 | 7 | 8 | 9 | 10 | 11 | 12 | 13 | 14 | 15 | 16 | 17 | 18 | 19 | 20 | 21 | 22 | 23 | 24 | 25 | 26 | 27 | 28 | 29 | 30 | 31 | 32 | 33 | 34 | 35 | 36 | 37 | 38 | 39 | 40 | 41 | 42 | 43 | 44 | 45 | | | | | | | | |
|---------|---|---|---|---------|--------|---|---|----|----|----|---------|---------|----|----|----|----|----|----|----|---------|----|----|----|----|----|----|----|----|----|----|----|----|----|----|----|----|----|----|----|----|----|----|----|--|--|--|--|--|--|--|--|
| M12x1,5 | | | | 3 - 6,5 | | | | | | | | | | | | | | | | | | | | | | | | | | | | | | | | | | | | | | | | | | | | | | | |
| M16x1,5 | | | | 4 - 8 | | | | | | | | | | | | | | | | | | | | | | | | | | | | | | | | | | | | | | | | | | | | | | | |
| M20x1,5 | | | | | 6 - 12 | | | | | | | | | | | | | | | | | | | | | | | | | | | | | | | | | | | | | | | | | | | | | | |
| M25x1,5 | | | | | | | | | | | 13 - 18 | | | | | | | | | | | | | | | | | | | | | | | | | | | | | | | | | | | | | | | | |
| M32x1,5 | | | | | | | | | | | | 16 - 21 | | | | | | | | | | | | | | | | | | | | | | | | | | | | | | | | | | | | | | | |
| M40x1,5 | | | | | | | | | | | | | | | | | | | | 20 - 26 | | | | | | | | | | | | | | | | | | | | | | | | | | | | | | | |
| M50x1,5 | | | | | | | | | | | | | | | | | | | | | | | | | | | | | | | | | | | | | | | | | | | | | | | | | | | |
| M63x1,5 | | | | | | | | | | | | | | | | | | | | | | | | | | | | | | | | | | | | | | | | | | | | | | | | | | | |

CAPACITÀ DI SERRAGGIO FILETTO PG IP68 (UL, CSA) · PG THREAD IP68 CLAMPING RANGE (UL, CSA)

| Passo | 3 | 4 | 5 | 6 | 7 | 8 | 9 | 10 | 11 | 12 | 13 | 14 | 15 | 16 | 17 | 18 | 19 | 20 | 21 | 22 | 23 | 24 | 25 | 26 | 27 | 28 | 29 | 30 | 31 | 32 | 33 | 34 | 35 | 36 | 37 | 38 | 39 | 40 | 41 | 42 | 43 | 44 | 45 | | | | | | | | | | |
|---------|---|---|---|---------|--------|--------|---------|----|----|----|----|---------|----|----|----|----|----|----|----|----|----|----|----|----|----|----|----|----|----|----|----|----|----|----|----|----|----|----|----|----|----|----|----|--|--|--|--|--|--|--|--|--|--|
| PG 7 | | | | 3 - 6,5 | | | | | | | | | | | | | | | | | | | | | | | | | | | | | | | | | | | | | | | | | | | | | | | | | |
| PG 9 | | | | 4 - 8 | | | | | | | | | | | | | | | | | | | | | | | | | | | | | | | | | | | | | | | | | | | | | | | | | |
| PG 11 | | | | | 5 - 10 | | | | | | | | | | | | | | | | | | | | | | | | | | | | | | | | | | | | | | | | | | | | | | | | |
| PG 13,5 | | | | | | 6 - 12 | | | | | | | | | | | | | | | | | | | | | | | | | | | | | | | | | | | | | | | | | | | | | | | |
| PG 16 | | | | | | | 10 - 13 | | | | | | | | | | | | | | | | | | | | | | | | | | | | | | | | | | | | | | | | | | | | | | |
| PG 21 | | | | | | | | | | | | 13 - 18 | | | | | | | | | | | | | | | | | | | | | | | | | | | | | | | | | | | | | | | | | |
| PG 29 | | | | | | | | | | | | | | | | | | | | | | | | | | | | | | | | | | | | | | | | | | | | | | | | | | | | | |
| PG 36 | | | | | | | | | | | | | | | | | | | | | | | | | | | | | | | | | | | | | | | | | | | | | | | | | | | | | |

CAPACITÀ DI SERRAGGIO FILETTO PG IP68 · PG THREAD IP68 CLAMPING RANGE

| Passo | 3 | 4 | 5 | 6 | 7 | 8 | 9 | 10 | 11 | 12 | 13 | 14 | 15 | 16 | 17 | 18 | 19 | 20 | 21 | 22 | 23 | 24 | 25 | 26 | 27 | 28 | 29 | 30 | 31 | 32 | 33 | 34 | 35 | 36 | 37 | 38 | 39 | 40 | 41 | 42 | 43 | 44 | 45 | | | | | | | | | | |
|---------|---|---|---|---------|--------|--------|---------|----|----|----|----|---------|----|----|----|----|----|----|----|----|----|----|----|----|----|----|----|----|----|----|----|----|----|----|----|----|----|----|----|----|----|----|----|--|--|--|--|--|--|--|--|--|--|
| PG 7 | | | | 3 - 6,5 | | | | | | | | | | | | | | | | | | | | | | | | | | | | | | | | | | | | | | | | | | | | | | | | | |
| PG 9 | | | | 4 - 8 | | | | | | | | | | | | | | | | | | | | | | | | | | | | | | | | | | | | | | | | | | | | | | | | | |
| PG 11 | | | | | 5 - 10 | | | | | | | | | | | | | | | | | | | | | | | | | | | | | | | | | | | | | | | | | | | | | | | | |
| PG 13,5 | | | | | | 6 - 11 | | | | | | | | | | | | | | | | | | | | | | | | | | | | | | | | | | | | | | | | | | | | | | | |
| PG 16 | | | | | | | 10 - 14 | | | | | | | | | | | | | | | | | | | | | | | | | | | | | | | | | | | | | | | | | | | | | | |
| PG 21 | | | | | | | | | | | | 13 - 18 | | | | | | | | | | | | | | | | | | | | | | | | | | | | | | | | | | | | | | | | | |
| PG 29 | | | | | | | | | | | | | | | | | | | | | | | | | | | | | | | | | | | | | | | | | | | | | | | | | | | | | |
| PG 36 | | | | | | | | | | | | | | | | | | | | | | | | | | | | | | | | | | | | | | | | | | | | | | | | | | | | | |
| PG 42 | | | | | | | | | | | | | | | | | | | | | | | | | | | | | | | | | | | | | | | | | | | | | | | | | | | | | |
| PG 48 | | | | | | | | | | | | | | | | | | | | | | | | | | | | | | | | | | | | | | | | | | | | | | | | | | | | | |

CAPACITÀ DI SERRAGGIO FILETTO PG IP54 · PG THREAD IP54 CLAMPING RANGE

| Passo | 3 | 4 | 5 | 6 | 7 | 8 | 9 | 10 | 11 | 12 | 13 | 14 | 15 | 16 | 17 | 18 | 19 | 20 | 21 | 22 | 23 | 24 | 25 | 26 | 27 | 28 | 29 | 30 | 31 | 32 | 33 | 34 | 35 | 36 | 37 | 38 | 39 | 40 | 41 | 42 | 43 | 44 | 45 | | | | | | | | | | |
|---------|---|---|---|---------|-------|---|--------|---------|----|----|----|---------|----|----|----|----|----|----|----|----|----|----|----|----|----|----|----|----|----|----|----|----|----|----|----|----|----|----|----|----|----|----|----|--|--|--|--|--|--|--|--|--|--|
| PG 7 | | | | 3,5 - 6 | | | | | | | | | | | | | | | | | | | | | | | | | | | | | | | | | | | | | | | | | | | | | | | | | |
| PG 9 | | | | 4,5 - 7 | | | | | | | | | | | | | | | | | | | | | | | | | | | | | | | | | | | | | | | | | | | | | | | | | |
| PG 11 | | | | | 6 - 9 | | | | | | | | | | | | | | | | | | | | | | | | | | | | | | | | | | | | | | | | | | | | | | | | |
| PG 13,5 | | | | | | | 9 - 12 | | | | | | | | | | | | | | | | | | | | | | | | | | | | | | | | | | | | | | | | | | | | | | |
| PG 16 | | | | | | | | 11 - 14 | | | | | | | | | | | | | | | | | | | | | | | | | | | | | | | | | | | | | | | | | | | | | |
| PG 21 | | | | | | | | | | | | 14 - 18 | | | | | | | | | | | | | | | | | | | | | | | | | | | | | | | | | | | | | | | | | |
| PG 29 | | | | | | | | | | | | | | | | | | | | | | | | | | | | | | | | | | | | | | | | | | | | | | | | | | | | | |
| PG 36 | | | | | | | | | | | | | | | | | | | | | | | | | | | | | | | | | | | | | | | | | | | | | | | | | | | | | |
| PG 42 | | | | | | | | | | | | | | | | | | | | | | | | | | | | | | | | | | | | | | | | | | | | | | | | | | | | | |
| PG 48 | | | | | | | | | | | | | | | | | | | | | | | | | | | | | | | | | | | | | | | | | | | | | | | | | | | | | |

CAPACITÀ DI SERRAGGIO FILETTO GAS IP54 · GAS THREAD IP54 CLAMPING RANGE

| Passo | 3 | 4 | 5 | 6 | 7 | 8 | 9 | 10 | 11 | 12 | 13 | 14 |
|-------|---|---|---|---|---|---|---|----|----|----|----|----|
|-------|---|---|---|---|---|---|---|----|----|----|----|----|

PASSO METRICO METRIC THREAD

PASSO METRICO · IP68 · STANDARD METRIC THREAD · IP68 · STANDARD

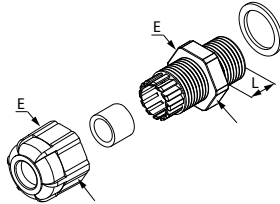

MATERIALE: poliammide (PA6.6), autoestinguente in accordo a: UL-94 - V2 e IEC 695-2-1 (850 °C)
TEMPERATURA D'ESERCIZIO: da -20 °C a +90 °C
GUARNIZIONE INTERNA E RONDELLA: NBR (gomma nitrilica), durezza 70 Shore A
NORME DI RIF.: EN 62444:2013

MATERIAL: polyamide (PA6.6), self-extinguishing according to: UL-94 V2 and IEC 695-2-1 (850 °C)
OPERATING TEMPERATURE: from -20 °C to +90 °C
INNER GASKET AND WASHER: NBR (nitrile rubber), 70 Shore A hardness
ACCORDING TO STD.: EN 62444:2013

| Grigio RAL 7035 Grey RAL 7035 | Nero RAL 9005 Black RAL 9005 | Filetto Thread size | Diametro cavi Cable clamping range | Chiave Nut | |
|----------------------------------|---------------------------------|------------------------|---------------------------------------|---------------|----|
| Articolo - Code | Articolo - Code | EN 60423 | ø mm | L | E |
| 4912 | 4912N | M 12 x 1,5 | 3 - 6,5 | 9 | 16 |
| 4917 | 4917N | M 16 x 1,5 | 4 - 8 | 9 | 19 |
| 4920 | 4920N | M 20 x 1,5 | 6 - 12 | 10 | 24 |
| 4925 | 4925N | M 25 x 1,5 | 13 - 18 | 12 | 33 |
| 4932 | 4932N | M 32 x 1,5 | 16 - 21 | 12 | 36 |
| 4940 | 4940N | M 40 x 1,5 | 20 - 26 | 15 | 46 |
| 4950 | 4950N | M 50 x 1,5 | 32 - 38 | 18 | 60 |
| 4963 | 4963N | M 63 x 1,5 | 37 - 44 | 18 | 68 |



IP68

PASSO METRICO · IP68 · CON DADO DI FISSAGGIO METRIC THREAD · IP68 · WITH LOCKNUT

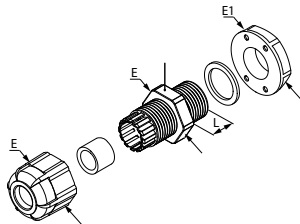

MATERIALE: poliammide (PA6.6), autoestinguente in accordo a: UL-94 - V2 e IEC 695-2-1 (850 °C)
DADO DI FISSAGGIO: con flangia
TEMPERATURA D'ESERCIZIO: da -20 °C a +90 °C
GUARNIZIONE INTERNA E RONDELLA: NBR (gomma nitrilica), durezza 70 Shore A
NORME DI RIF.: EN 62444:2013

MATERIAL: polyamide (PA6.6), self-extinguishing according to: UL-94 V2 and IEC 695-2-1 (850 °C)
LOCKNUT: with flange
OPERATING TEMPERATURE: from -20 °C to +90 °C
INNER GASKET AND WASHER: NBR (nitrile rubber), 70 Shore A hardness
ACCORDING TO STD.: EN 62444:2013

| Grigio RAL 7035 Grey RAL 7035 | Nero RAL 9005 Black RAL 9005 | Filetto Thread size | Diametro cavi Cable clamping range | Chiave Nut | Chiave Locknut | |
|----------------------------------|---------------------------------|------------------------|---------------------------------------|---------------|-------------------|----|
| Articolo - Code | Articolo - Code | EN 60423 | ø mm | L | E | E1 |
| 4712 | 4712N | M 12 x 1,5 | 3 - 6,5 | 9 | 16 | 17 |
| 4717 | 4717N | M 16 x 1,5 | 4 - 8 | 9 | 19 | 22 |
| 4720 | 4720N | M 20 x 1,5 | 6 - 12 | 10 | 24 | 26 |
| 4725 | 4725N | M 25 x 1,5 | 13 - 18 | 12 | 33 | 32 |
| 4732 | 4732N | M 32 x 1,5 | 16 - 21 | 12 | 36 | 41 |
| 4740 | 4740N | M 40 x 1,5 | 20 - 26 | 15 | 46 | 49 |
| 4750 | 4750N | M 50 x 1,5 | 32 - 38 | 18 | 60 | 61 |
| 4763 | 4763N | M 63 x 1,5 | 37 - 44 | 18 | 68 | 73 |



IP68

PASSO METRICO · IP68 · CON FILETTO LUNGO
 METRIC THREAD · IP68 · WITH LONG THREAD

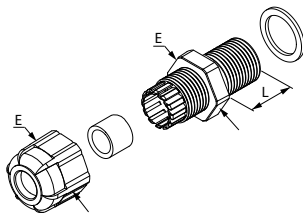

MATERIALE: poliammide (PA6.6), autoestinguente in accordo a: UL-94 - V2 e IEC 695-2-1 (850 °C)
TEMPERATURA D'ESERCIZIO: da -20 °C a +90 °C
GUARNIZIONE INTERNA E RONDELLA: NBR (gomma nitrilica), durezza 70 Shore A
NORME DI RIF.: EN 62444:2013

MATERIAL: polyamide (PA6.6), self-extinguishing according to: UL-94 V2 and IEC 695-2-1 (850 °C)
OPERATING TEMPERATURE: from -20 °C to +90 °C
INNER GASKET AND WASHER: NBR (nitrile rubber), 70 Shore A hardness
ACCORDING TO STD.: EN 62444:2013

| Grigio RAL 7035 Grey RAL 7035 | Nero RAL 9005 Black RAL 9005 | Filetto Thread size | Diametro cavi Cable clamping range | Chiave Nut | |
|----------------------------------|---------------------------------|------------------------|---------------------------------------|---------------|----|
| Articolo - Code | Articolo - Code | EN 60423 | ø mm | L | E |
| 4912L | 4912LN | M 12 x 1,5 | 3 - 6,5 | 15 | 16 |
| 4917L | 4917LN | M 16 x 1,5 | 4 - 8 | 15 | 19 |
| 4920L | 4920LN | M 20 x 1,5 | 6 - 12 | 15 | 24 |
| 4925L | 4925LN | M 25 x 1,5 | 13 - 18 | 15 | 33 |
| 4932L | 4932LN | M 32 x 1,5 | 16 - 21 | 15 | 36 |
| 4940L | 4940LN | M 40 x 1,5 | 20 - 26 | 18 | 46 |
| 4950L | 4950LN | M 50 x 1,5 | 32 - 38 | 20 | 60 |
| 4963L | 4963LN | M 63 x 1,5 | 37 - 44 | 20 | 68 |



IP68

PASSO METRICO · IP68 · CON SPIRALE PROTEGGI-CAVO
 METRIC THREAD · IP68 · WITH SPIRAL CABLE PROTECTION

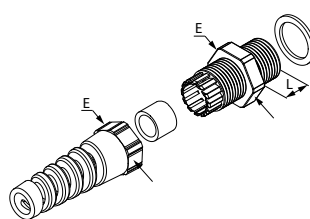

MATERIALE: poliammide (PA6.6), autoestinguente in accordo a: UL-94 - V2 e IEC 695-2-1 (850 °C)
TEMPERATURA D'ESERCIZIO: da -20 °C a +90 °C
GUARNIZIONE INTERNA E RONDELLA: NBR (gomma nitrilica), durezza 70 Shore A
NORME DI RIF.: EN 62444:2013

MATERIAL: polyamide (PA6.6), self-extinguishing according to: UL-94 V2 and IEC 695-2-1 (850 °C)
OPERATING TEMPERATURE: from -20 °C to +90 °C
INNER GASKET AND WASHER: NBR (nitrile rubber), 70 Shore A hardness
ACCORDING TO STD.: EN 62444:2013

| Grigio RAL 7035 Grey RAL 7035 | Nero RAL 9005 Black RAL 9005 | Filetto Thread size | Diametro cavi Cable clamping range | Chiave Nut | |
|----------------------------------|---------------------------------|------------------------|---------------------------------------|---------------|----|
| Articolo - Code | Articolo - Code | EN 60423 | ø mm | L | E |
| 4912S | 4912SN | M 12 x 1,5 | 3 - 6,5 | 15 | 16 |
| 4917S | 4917SN | M 16 x 1,5 | 4 - 8 | 15 | 19 |
| 4920S | 4920SN | M 20 x 1,5 | 6 - 12 | 15 | 24 |
| 4925S | 4925SN | M 25 x 1,5 | 13 - 18 | 15 | 33 |



IP68

PASSO METRICO · ACCESSORI: DADI ESAGONALI CON FLANGIA

METRIC THREAD · ACCESSORIES: HEXAGONAL LOCKNUTS WITH FLANGE

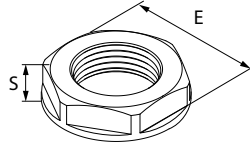

MATERIALE:
 poliammide rinforzato
 con fibra di vetro
TEMPERATURA D'ESERCIZIO:
 da -20 °C a +90 °C

MATERIAL:
 polyamide reinforced with fiberglass
OPERATING TEMPERATURE:
 from -20 °C to +90 °C

| Grigio RAL 7035 Grey RAL 7035 | Nero RAL 9005 Black RAL 9005 | Filetto Thread size | | | | |
|----------------------------------|---------------------------------|------------------------|----|---|--|---------|
| Articolo - Code | Articolo - Code | EN 60423 | E | S | | |
| 4812 | 4812N | M 12 x 1,5 | 17 | 5 | | |
| 4817 | 4817N | M 16 x 1,5 | 22 | 5 | | |
| 4820 | 4820N | M 20 x 1,5 | 26 | 6 | | 100/500 |
| 4825 | 4825N | M 25 x 1,5 | 32 | 6 | | |
| 4832 | 4832N | M 32 x 1,5 | 41 | 7 | | 50/50 |
| 4840 | 4840N | M 40 x 1,5 | 50 | 7 | | 25/25 |
| 4850 | 4850N | M 50 x 1,5 | 60 | 8 | | |
| 4863 | 4863N | M 63 x 1,5 | 75 | 8 | | 10/10 |

PASSO METRICO · IP56 · ACCESSORI: TAPPI DI CHIUSURA

METRIC THREAD · IP56 · ACCESSORIES: STOP-ENDS

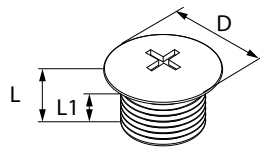

MATERIALE:
 poliammide rinforzato con fibra di vetro
TEMPERATURA D'ESERCIZIO:
 da -40 °C a +100 °C

MATERIAL:
 polyamide reinforced with fiberglass
OPERATING TEMPERATURE:
 from -40 °C to +100 °C

| Grigio RAL 7035 Grey RAL 7035 | Nero RAL 9005 Black RAL 9005 | Filetto Thread size | | | | |
|----------------------------------|---------------------------------|------------------------|----|------|----|---------|
| Articolo - Code | Articolo - Code | EN 60423 | D | L | L1 | |
| 4612 | 4612N | M 12 x 1,5 | 15 | 8 | 6 | |
| 4616 | 4616N | M 16 x 1,5 | 20 | 9 | 6 | |
| 4620 | 4620N | M 20 x 1,5 | 24 | 9,5 | 6 | 100/100 |
| 4625 | 4625N | M 25 x 1,5 | 30 | 10 | 8 | |
| 4632 | 4632N | M 32 x 1,5 | 37 | 13,5 | 8 | |
| 4640 | 4640N | M 40 x 1,5 | 46 | 15 | 8 | |
| 4650 | 4650N | M 50 x 1,5 | 56 | 16 | 10 | 50/50 |
| 4663 | 4663N | M 63 x 1,5 | 70 | 16 | 12 | 25/25 |

IP56

PASSO METRICO · ACCESSORI: GUARNIZIONI PIATTE
METRIC THREAD · ACCESSORIES: FLAT GASKETS

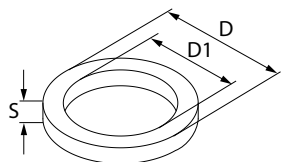

MATERIALE:
 NBR (gomma nitrilica), durezza 60 Shore A
 Resistente agli olii e ai grassi
TEMPERATURA DI ESERCIZIO:
 da -20 °C a +90 °C

MATERIAL:
 NBR (nitrile rubber), 60 Shore A hardness
 Resistant to oils and grease
OPERATING TEMPERATURE:
 from -20 °C to +90 °C

| Articolo Code | Filetto Thread | D | D1 | S | |
|------------------|-------------------|----|------|---|---------|
| 4912G | M 12 | 16 | 11,8 | 2 | 100/500 |
| 4917G | M 16 | 20 | 15,8 | 2 | |
| 4920G | M 20 | 24 | 19,8 | 2 | |
| 4925G | M 25 | 29 | 24,8 | 2 | |
| 4932G | M 32 | 36 | 31,8 | 2 | |
| 4940G | M 40 | 46 | 39,8 | 2 | 100/100 |
| 4950G | M 50 | 56 | 49,8 | 2 | |
| 4963G | M 63 | 69 | 62,8 | 2 | |

PASSO PG
PG THREAD

PASSO PG · IP68 · STANDARD
PG THREAD · IP68 · STANDARD

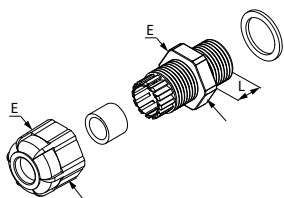

MATERIALE: poliammide (PA6.6),
 autoestinguente in accordo a:
 UL-94 - V2 e IEC 695-2-1 (850 °C)
TEMPERATURA D'ESERCIZIO:
 da -20 °C a +90 °C
GUARNIZIONE INTERNA E RONDELLA:
 NBR (gomma nitrilica), durezza 70 Shore A
NORME DI RIF.: EN 62444:2013

MATERIAL: polyamide (PA6.6),
 self-extinguishing according to:
 UL-94 V2 and IEC 695-2-1 (850 °C)
OPERATING TEMPERATURE:
 from 0 °C to +90 °C
INNER GASKET AND WASHER:
 NBR (nitrile rubber), 70 Shore A hardness
ACCORDING TO STD.: EN 62444:2013

| Grigio RAL 7035 Grey RAL 7035 | Grigio RAL 7001 Grey RAL 7001 | Nero RAL 9005 Black RAL 9005 | Filetto Thread size | Diametro cavi Cable clamping range | Chiave Nut | |
|----------------------------------|----------------------------------|---------------------------------|------------------------|---------------------------------------|---------------|--------|
| Articolo - Code | Articolo - Code | Articolo - Code | DIN 40430 | ø mm | L E | |
| 4007 | 4307 | 4007N | PG 7 | 3 - 6,5 | 9 16 | 50/500 |
| 4009 | 4309 | 4009N | PG 9 | 4 - 8 | 9 19 | |
| 4011 | 4311 | 4011N | PG 11 | 5 - 10 | 9 22 | |
| 4013 | 4313 | 4013N | PG 13,5 | 6 - 11 | 10 24 | 25/25 |
| 4016 | 4316 | 4016N | PG 16 | 10 - 13 | 10 27 | |
| 4021 | 4321 | 4021N | PG 21 | 13 - 18 | 12 33 | 20/200 |
| 4029 | 4329 | 4029N | PG 29 | 18 - 25 | 12 42 | 10/100 |
| 4036 | 4336 | 4036N | PG 36 | 25 - 32 | 15 52 | |
| 4042 | 4342 | 4042N | PG 42 | 32 - 38 | 18 60 | 5/50 |
| 4048 | 4348 | 4048N | PG 48 | 37 - 44 | 18 68 | |



IP68

PASSO PG · IP68 · CON DADO DI FISSAGGIO

PG THREAD · IP68 · WITH LOCKNUT

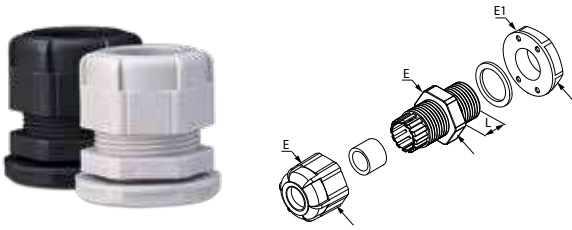

MATERIALE: poliammide (PA6,6), autoestinguente in accordo a: UL-94 - V2 e IEC 695-2-1 (850 °C)
TEMPERATURA D'ESERCIZIO: da -20 °C a +90 °C
GUARNIZIONE INTERNA E RONDELLA: NBR (gomma nitrilica), durezza 70 Shore A
NORME DI RIF.: EN 62444:2013

MATERIAL: polyamide (PA6.6), self-extinguishing according to: UL-94 V2 and IEC 695-2-1 (850 °C)
OPERATING TEMPERATURE: from -20 °C to +90 °C
INNER GASKET AND WASHER: NBR (nitrile rubber), 70 Shore A hardness
ACCORDING TO STD.: EN 62444:2013

| Grigio RAL 7035 Grey RAL 7035 | Nero RAL 9005 Black RAL 9005 | Filetto Thread size | Diametro cavi Cable clamping range | Chiave Nut | Chiave Locknut | |
|----------------------------------|---------------------------------|------------------------|---------------------------------------|---------------|-------------------|--------|
| Articolo - Code | Articolo - Code | DIN 40430 | ø mm | L | E | |
| 4707 | 4707N | PG 7 | 3 - 6,5 | 9 | 16 | |
| 4709 | 4709N | PG 9 | 4 - 8 | 9 | 19 | |
| 4711 | 4711N | PG 11 | 5 - 10 | 9 | 22 | |
| 4713 | 4713N | PG 13,5 | 6 - 11 | 10 | 24 | 10/100 |
| 4716 | 4716N | PG 16 | 10 - 13 | 10 | 27 | |
| 4721 | 4721N | PG 21 | 13 - 18 | 12 | 33 | |
| 4729 | 4729N | PG 29 | 18 - 25 | 12 | 42 | 10/50 |
| 4736 | 4736N | PG 36 | 25 - 32 | 15 | 52 | |
| 4742 | 4742N | PG 42 | 32 - 38 | 18 | 60 | 5/5 |
| 4748 | 4748N | PG 48 | 37 - 44 | 18 | 68 | 69 |

IP68
PASSO PG · IP68 · CON FLANGIA

PG THREAD · IP68 · WITH FLANGE

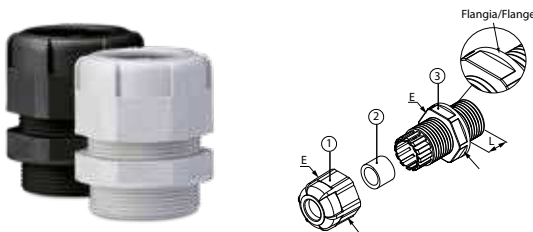

MATERIALE: poliammide (PA6,6), autoestinguente in accordo a: UL-94 - V2 e IEC 695-2-1 (850 °C)
TEMPERATURA D'ESERCIZIO: da -20 °C a +90 °C
GUARNIZIONE INTERNA: NBR (gomma nitrilica), durezza 60 Shore A
NORME DI RIF.: EN 62444:2013

MATERIAL: polyamide (PA6.6), self-extinguishing according to: UL-94 V2 and IEC 695-2-1 (850 °C)
OPERATING TEMPERATURE: from -20 °C to +90 °C
INNER GASKET: NBR (nitrile rubber), 60 Shore A hardness
ACCORDING TO STD.: EN 62444:2013

| Grigio RAL 7035 Grey RAL 7035 | Nero RAL 9005 Black RAL 9005 | Filetto Thread size | Diametro cavi Cable clamping range | Chiave Nut | |
|----------------------------------|---------------------------------|------------------------|---------------------------------------|---------------|----|
| Articolo - Code | Articolo - Code | DIN 40430 | ø mm | L | E |
| 4907** | 49071** | PG 7 | 3 - 6,5 | 8 | 15 |
| 4909** | 49091** | PG 9 | 4 - 8 | 8 | 19 |
| 4911** | 49111** | PG 11 | 5 - 10 | 8 | 22 |
| 4913* | 49131* | PG 13,5 | 6 - 12 | 10 | 24 |
| 4916* | 49161* | PG 16 | 10 - 14 | 10 | 27 |
| 4921* | 49211* | PG 21 | 13 - 18 | 11 | 33 |
| 4929 | 49291 | PG 29 | 18 - 25 | 11 | 42 |
| 4936* | 49361* | PG 36 | 22 - 32 | 13 | 53 |

Quando si installa il pressacavo su pannelli con foro passante, per mantenere le certificazioni UL e CSA, è necessario usare i dadi 48xx a pagina 195.
 When installing the cable gland on panels with through hole, you need to use the 48xx nuts on page 195 to preserve UL and CSA certifications.

* file n° E171361

** file n° E171361

LR 44081-10

IP68

PASSO PG · IP68 · CON FILETTO LUNGO

PG THREAD · IP68 · WITH LONG THREAD

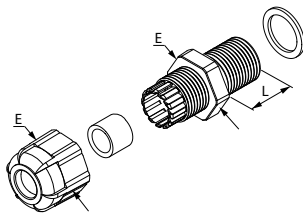

MATERIALE: poliammide (PA6.6), autoestinguente in accordo a: UL-94 - V2 e IEC 695-2-1 (850 °C)
TEMPERATURA D'ESERCIZIO: da -20 °C a +90 °C
GUARNIZIONE INTERNA E RONDELLA: NBR (gomma nitrilica), durezza 70 Shore A
NORME DI RIF.: EN 62444:2013

MATERIAL: polyamide (PA6.6), self-extinguishing according to: UL-94 V2 and IEC 695-2-1 (850 °C)
OPERATING TEMPERATURE: from -20 °C to +90 °C
INNER GASKET AND WASHER: NBR (nitrile rubber), 70 Shore A hardness
ACCORDING TO STD.: EN 62444:2013

| Grigio RAL 7035 Grey RAL 7035 | Nero RAL 9005 Black RAL 9005 | Filetto Thread size | Diametro cavi Cable clamping range | Chiave Nut | |
|----------------------------------|---------------------------------|------------------------|---------------------------------------|---------------|-------|
| Articolo - Code | Articolo - Code | DIN 40430 | ø mm | L E | |
| 4007L | 4007LN | PG 7 | 3 - 6,5 | 15 16 | 25/25 |
| 4009L | 4009LN | PG 9 | 4 - 8 | 15 19 | |
| 4011L | 4011LN | PG 11 | 5 - 10 | 15 22 | |
| 4013L | 4013LN | PG 13,5 | 6 - 11 | 15 24 | 10/10 |
| 4016L | 4016LN | PG 16 | 10 - 13 | 15 27 | |
| 4021L | 4021LN | PG 21 | 13 - 18 | 15 33 | |
| 4029L | 4029LN | PG 29 | 18 - 25 | 15 42 | |
| 4036L | 4036LN | PG 36 | 25 - 32 | 18 52 | 5/5 |
| 4042L | 4042LN | PG 42 | 32 - 38 | 20 60 | 3/3 |
| 4048L | 4048LN | PG 48 | 37 - 44 | 20 68 | |



IP68

PASSO PG · IP68 · CON SPIRALE PROTEGGI-CAVO

PG THREAD · IP68 · WITH SPIRAL CABLE PROTECTION

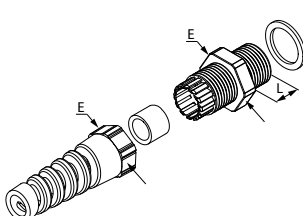

MATERIALE: poliammide (PA6.6), autoestinguente in accordo a: UL-94 - V2 e IEC 695-2-1 (850 °C)
TEMPERATURA D'ESERCIZIO: da -20 °C a +90 °C
GUARNIZIONE INTERNA E RONDELLA: NBR (gomma nitrilica), durezza 70 Shore A
NORME DI RIF.: EN 62444:2013

MATERIAL: polyamide (PA6.6), self-extinguishing according to: UL-94 V2 and IEC 695-2-1 (850 °C)
OPERATING TEMPERATURE: from -20 °C to +90 °C
INNER GASKET AND WASHER: NBR (nitrile rubber), 70 Shore A hardness
ACCORDING TO STD.: EN 62444:2013

| Grigio RAL 7035 Grey RAL 7035 | Nero RAL 9005 Black RAL 9005 | Filetto Thread size | Diametro cavi Cable clamping range | Chiave Nut | |
|----------------------------------|---------------------------------|------------------------|---------------------------------------|---------------|-------|
| Articolo - Code | Articolo - Code | DIN 40430 | ø mm | L E | |
| 4007S | 4007SN | PG 7 | 3 - 6,5 | 15 16 | 25/25 |
| 4009S | 4009SN | PG 9 | 4 - 8 | 15 19 | |
| 4011S | 4011SN | PG 11 | 5 - 10 | 15 22 | |
| 4013S | 4013SN | PG 13,5 | 6 - 11 | 15 24 | 10/10 |
| 4016S | 4016SN | PG 16 | 10 - 13 | 15 27 | |
| 4021S | 4021SN | PG 21 | 13 - 16 | 15 33 | |



IP68

PASSO PG · IP54 · RINFORZATO IN FIBRA DI VETRO

PG THREAD · IP54 · REINFORCED WITH FIBERGLASS

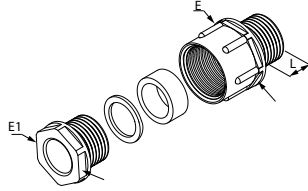

MATERIALE:
 poliammide rinforzato con fibra di vetro
AUTOESTINGUENZA: UL 94 - HB
TEMPERATURA D'ESERCIZIO:
 da -20 °C a +80 °C
NORME DI RIF.: DIN 46320

MATERIAL:
 polyamide reinforced with fiberglass
SELF-EXTINGUISHING: UL 94 - HB
OPERATING TEMPERATURE:
 from -20 °C to +80 °C
ACCORDING TO STD.: DIN 46320

| Grigio RAL 7035 Grey RAL 7035 | Filetto Thread size | Diametro cavi Cable clamping range | Chiave Nut | Chiave Locknut | | |
|----------------------------------|------------------------|---------------------------------------|---------------|-------------------|----|-------|
| Articolo - Code | DIN 40430 | ø mm | L | E | E1 | |
| 3596 | PG 7 | 3,5 - 6 | 8 | 15 | 13 | |
| 3597 | PG 9 | 4,5 - 7 | 8 | 19 | 16 | |
| 3598 | PG 11 | 6 - 9 | 8 | 22 | 19 | 50/50 |
| 3599 | PG 13,5 | 9 - 12 | 9 | 24 | 21 | |
| 3600 | PG 16 | 11 - 14 | 10 | 27 | 23 | |
| 3601 | PG 21 | 14 - 18 | 11 | 33 | 30 | 25/25 |
| 3602 | PG 29 | 18 - 25 | 11 | 42 | 40 | 20/20 |
| 3603 | PG 36 | 25 - 32 | 13 | 53 | 50 | 10/10 |
| 3604 | PG 42 | 30 - 38 | 13 | 60 | 55 | |
| 3605 | PG 48 | 38 - 44 | 15 | 65 | 60 | 5/5 |

IP54

PASSO PG · ACCESSORI: DADI ESAGONALI

PG THREAD · ACCESSORIES: HEXAGONAL LOCKNUTS

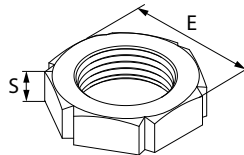

MATERIALE:
 poliammide rinforzato con fibra di vetro
TEMPERATURA DI ESERCIZIO:
 da -20 °C a +90 °C

MATERIAL:
 polyamide reinforced with fiberglass
OPERATING TEMPERATURE:
 from -20 °C to +90 °C

| Grigio RAL 7035 Grey RAL 7035 | Filetto Thread size | | | |
|----------------------------------|------------------------|----|---|---------|
| Articolo - Code | DIN 40430 | E | S | |
| 3696 | PG 7 | 19 | 5 | |
| 3697 | PG 9 | 22 | 5 | |
| 3698 | PG 11 | 24 | 4 | 100/100 |
| 3699 | PG 13,5 | 27 | 6 | |
| 3700 | PG 16 | 30 | 6 | |
| 3701 | PG 21 | 36 | 7 | |
| 3702 | PG 29 | 46 | 7 | 50/50 |
| 3703 | PG 36 | 60 | 8 | 25/25 |
| 3704 | PG 42 | 65 | 8 | |
| 3705 | PG 48 | 70 | 8 | 10/10 |

PASSO PG · ACCESSORI: DADI ESAGONALI CON FLANGIA

PG THREAD · ACCESSORIES: HEXAGONAL LOCKNUTS WITH FLANGE

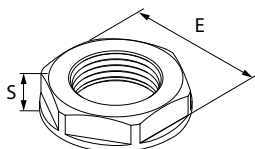

MATERIALE:
poliammide rinforzato con fibra di vetro
TEMPERATURA DI ESERCIZIO:
da -20 °C a +90 °C

MATERIAL:
polyamide reinforced with fiberglass
OPERATING TEMPERATURE:
from -20 °C to +90 °C

| Grigio RAL 7035 Grey RAL 7035 | Nero RAL 9005 Black RAL 9005 | Filetto Thread size | | | |
|----------------------------------|---------------------------------|------------------------|----|---|---------|
| Articolo - Code | Articolo - Code | DIN 40430 | E | S | |
| 4807** | 4807N** | PG 7 | 19 | 5 | |
| 4809** | 4809N** | PG 9 | 22 | 5 | |
| 4811** | 4811N** | PG 11 | 24 | 5 | |
| 4813* | 4813N* | PG 13,5 | 27 | 6 | 100/500 |
| 4816* | 4816N* | PG 16 | 30 | 6 | |
| 4821* | 4821N* | PG 21 | 36 | 7 | |
| 4829 | 4829N | PG 29 | 46 | 7 | 50/50 |
| 4836* | 4836N* | PG 36 | 60 | 8 | 25/25 |
| 4842 | 4842N | PG 42 | 65 | 8 | |
| 4848 | 4848N | PG 48 | 70 | 8 | 10/10 |

Utilizzare questi dadi per preservare le certificazioni UL e CSA dei pressacavi 49xx a pagina 192 installati su pannelli a foro passante.
Use these nuts to preserve UL and CSA certifications of the 49XX cable glands on page 192 when installed on through-hole panels.



* file n° E171361



** file n° E171361



LR 44081-10

PASSO PG · IP56 · ACCESSORI: TAPPI DI CHIUSURA

PG THREAD · IP56 · ACCESSORIES: STOP-ENDS

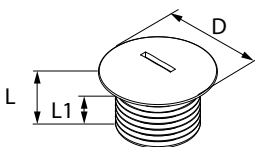

MATERIALE: polistirene
TEMPERATURA D'ESERCIZIO:
da -25 °C a +60 °C
PER BREVI PERIODI: +80 °C

MATERIAL: polystyrene
OPERATING TEMPERATURE:
from -25 °C to +60 °C
FOR SHORT PERIODS: +80 °C

| Grigio RAL 7035 Grey RAL 7035 | Nero RAL 9005 Black RAL 9005 | Filetto Thread size | | | |
|----------------------------------|---------------------------------|------------------------|----|-----|----|
| Articolo - Code | Articolo - Code | DIN 40430 | D | L | L1 |
| 4596 | 4596N | PG 7 | 15 | 8 | 6 |
| 4597 | 4597N | PG 9 | 19 | 9 | 6 |
| 4598 | 4598N | PG 11 | 22 | 9 | 6 |
| 4599 | 4599N | PG 13,5 | 25 | 9,5 | 6 |
| 4600 | 4600N | PG 16 | 27 | 9,5 | 6 |
| 4601 | 4601N | PG 21 | 33 | 11 | 8 |
| 4602 | 4602N | PG 29 | 44 | 12 | 8 |
| 4603 | 4603N | PG 36 | 55 | 15 | 10 |
| 4604 | 4604N | PG 42 | 62 | 16 | 10 |
| 4605 | 4605N | PG 48 | 69 | 16 | 12 |

IP56

PASSO PG · ACCESSORI: GUARNIZIONI PIATTE

PG THREAD · ACCESSORIES: FLAT GASKETS

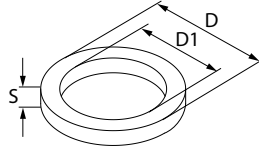

MATERIALE:
NBR (gomma nitrilica), durezza 60 Shore A
Resistente agli olii e ai grassi
TEMPERATURA DI ESERCIZIO:
da -20 °C a +90 °C

MATERIAL:
NBR (nitrile rubber), 60 Shore A hardness
Resistant to oils and grease
OPERATING TEMPERATURE:
from -20 °C to +90 °C

| Articolo Code | Filetto Thread | D | D1 | S | |
|------------------|-------------------|------|------|---|---------|
| 4907G | PG 7 | 16,5 | 12,5 | 2 | |
| 4909G | PG 9 | 19 | 15,2 | 2 | |
| 4911G | PG 11 | 22,5 | 18,6 | 2 | |
| 4913G | PG 13,5 | 25 | 20,4 | 2 | 100/500 |
| 4916G | PG 16 | 27 | 22,5 | 2 | |
| 4921G | PG 21 | 33,5 | 28,3 | 3 | |
| 4929G | PG 29 | 43,5 | 37 | 3 | |
| 4936G | PG 36 | 55 | 47 | 3 | |
| 4942G | PG 42 | 63 | 54 | 3 | 100/100 |
| 4948G | PG 48 | 69 | 59,3 | 3 | |

PASSO GAS GAS THREAD

PASSO GAS · IP54 · STANDARD

GAS THREAD · IP54 · STANDARD

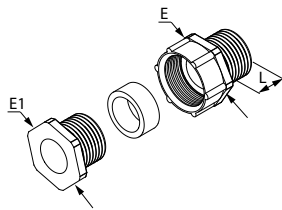

MATERIALE: poliammide (PA6.6)
AUTOESTINGUENZA:
UL 94 V-2 IEC 695-2-1 a 850 °C
TEMPERATURA D'ESERCIZIO:
da -20 °C a +90 °C

MATERIAL: polyamide (PA6.6)
SELF-EXTINGUISHING:
UL 94 V-2 IEC 695-2-1 at 850 °C
OPERATING TEMPERATURE:
from -20 °C to +90 °C

| Grigio RAL 7035 Grey RAL 7035 | Filetto Gas Gas thread | Diametro cavi Cable clamping range | Chiave Nut | Chiave Locknut | |
|----------------------------------|---------------------------|---------------------------------------|---------------|-------------------|----|
| Articolo - Code | ISO 228/1 | ø mm | L | E | E1 |
| 3451 | G 3/8" | 7 - 10 | 7,5 | 21 | 19 |
| 3452 | G 1/2" | 11 - 13 | 9 | 25 | 23 |
| 3453 | G 5/8" | 13,5 - 15 | 10 | 27 | 25 |
| 3454 | G 3/4" | 16 - 18 | 10,5 | 30 | 29 |
| 3455 | G 1" | 19 - 22 | 12 | 38 | 36 |



IP54

PASSO GAS · ACCESSORI: DADI ESAGONALI

GAS THREAD · ACCESSORIES: HEXAGONAL LOCKNUTS

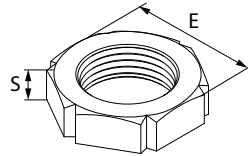

MATERIALE:
poliammide rinforzato con fibra di vetro
TEMPERATURA DI ESERCIZIO:
da -20 °C a +90 °C

MATERIAL:
polyamide reinforced with fiberglass
OPERATING TEMPERATURE:
from -20 °C to +90 °C

| Grigio RAL 7035 Grey RAL 7035 | Filetto Gas Gas thread |  | | |
|----------------------------------|---------------------------|---|-----|---------|
| Articolo - Code | ISO 228/1 | E | S | |
| 3461 | G 3/8" | 22 | 5,5 | |
| 3462 | G 1/2" | 27 | 5,5 | |
| 3463 | G 5/8" | 30 | 6 | 100/100 |
| 3464 | G 3/4" | 32 | 6,5 | |
| 3465 | G 1" | 39 | 7,5 | 50/50 |

ACCESSORI: FERMACAVI

ACCESSORIES: CABLE CLAMPS

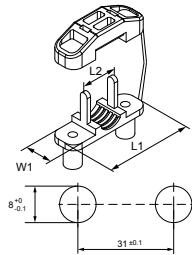

MATERIALE: poliammide (PA6,6)
 nero UL 94 - V2
TEMPERATURA D'ESERCIZIO: 125 °C
 Completo di due viti per materiali plastici M3,
 5x16 per il fissaggio del supporto fermacavo
 su lamiera con spessore da 0,6 a 1,5 mm.
 Adatto per il bloccaggio di cavi con sezioni
 da 3x0,75 a 3x2,5 mm² o con diametro
 esterno da 6 a 13 mm.
 Interasse tra i fori di fissaggio sulla lamiera:
 31 - 0,1 mm.
 Diametro fori: 8 + 0 - 0,1.

MATERIAL: polyamide (PA6.6)
 black UL 94 - V2
OPERATING TEMPERATURE: 125 °C
 Complete with two screws for M3 plastic
 materials, 5x16 for fastening the cable holder
 on metal sheets with thickness from 0.6 to
 1.5 mm. Suitable for the clamping of cables
 with sections from
 3x0.75 to 3x2.5 mm² or with external
 diameter from 6 to 13 mm. Distance between
 the fixing holes on metal sheet: 31 - 0.1 mm.
 Holes diameter: 8 + 0 - 0.1.

 Articolo
 Code



| | A | B | C | |
|-------------|------|------|------|---------|
| M932 | 44,3 | 14,6 | 14,5 | 100/100 |

PASSO METRICO

METRIC THREAD

PASSO METRICO · IP68 · STANDARD

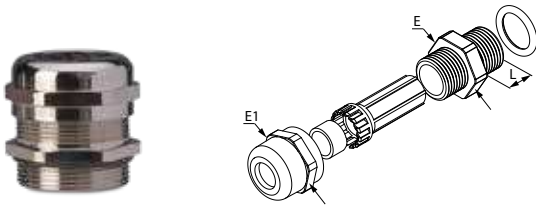
METRIC THREAD · IP68 · STANDARD



MATERIALE: ottone nichelato
TEMPERATURA D'ESERCIZIO:
 da -40 °C a +100 °C
GUARNIZIONE INTERNA E O-RING:
 NBR (gomma nitrilica), durezza 70 Shore A
GABBIA: poliammide (PA6.6)

MATERIAL: nickel-plated brass
OPERATING TEMPERATURE:
 from -40 °C to +100 °C
INNER GASKET AND O-RING:
 NBR (nitrile rubber), 70 Shore A hardness
CAGE: polyamide (PA6.6)

| Articolo Code | Filetto Thread size | Diametro cavi Cable clamping range | Chiave Nut | Chiave Locknut | |
|------------------|------------------------|---------------------------------------|---------------|-------------------|----|
| | EN 60423 | ø mm | L | E | E1 |
| 2512 | M 12 x 1,5 | 3 - 6,5 | 6 | 14 | 14 |
| 2517 | M 16 x 1,5 | 4 - 8 | 7 | 18 | 18 |
| 2520 | M 20 x 1,5 | 6 - 12 | 9 | 22 | 22 |
| 2525 | M 25 x 1,5 | 10 - 14 | 9 | 27 | 24 |
| 2532 | M 32 x 1,5 | 15 - 22 | 10 | 34 | 34 |
| 2540 | M 40 x 1,5 | 18 - 25 | 10 | 45 | 45 |
| 2550 | M 50 x 1,5 | 32 - 38 | 10 | 58 | 58 |
| 2563 | M 63 x 1,5 | 37 - 44 | 12 | 68 | 64 |



IP68

PASSO METRICO · IP68 · CON FILETTO LUNGO

METRIC THREAD · IP68 · WITH LONG THREAD

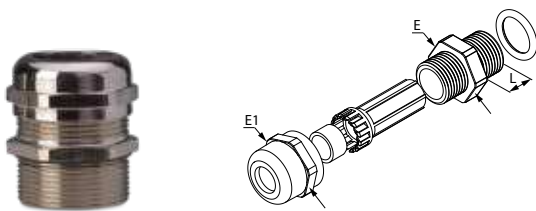

MATERIALE: ottone nichelato
TEMPERATURA D'ESERCIZIO:
 da -40 °C a +100 °C
GUARNIZIONE INTERNA E O-RING:
 NBR (gomma nitrilica), durezza 70 Shore A
GABBIA: poliammide (PA6.6)

MATERIAL: nickel-plated brass
OPERATING TEMPERATURE:
 from -40 °C to +100 °C
INNER GASKET AND O-RING:
 NBR (nitrile rubber), 70 Shore A hardness
CAGE: polyamide (PA6.6)

| Articolo Code | Filetto Thread size | Diametro cavi Cable clamping range | Chiave Nut | Chiave Locknut | |
|------------------|------------------------|---------------------------------------|---------------|-------------------|----|
| | EN 60423 | ø mm | L | E | E1 |
| 2512L | M 12 x 1,5 | 3 - 6,5 | 10 | 14 | 14 |
| 2517L | M 16 x 1,5 | 4 - 8 | 10 | 18 | 18 |
| 2520L | M 20 x 1,5 | 6 - 12 | 10 | 22 | 22 |
| 2525L | M 25 x 1,5 | 10 - 14 | 12 | 27 | 24 |
| 2532L | M 32 x 1,5 | 15 - 22 | 14 | 34 | 34 |
| 2540L | M 40 x 1,5 | 18 - 25 | 15 | 45 | 45 |
| 2550L | M 50 x 1,5 | 32 - 38 | 15 | 58 | 58 |
| 2563L | M 63 x 1,5 | 37 - 44 | 15 | 68 | 64 |



IP68

PASSO METRICO · IP54 · STANDARD
 METRIC THREAD · IP54 · STANDARD

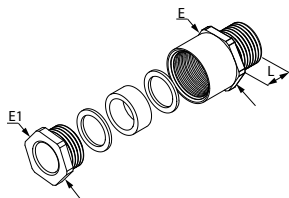

MATERIALE: ottone nichelato
TEMPERATURA D'ESERCIZIO:
 da -20 °C a +70 °C
GUARNIZIONE INTERNA:
 NBR (gomma nitrilica), durezza 70 Shore A

MATERIAL: nickel-plated brass
OPERATING TEMPERATURE:
 from -20 °C to +70 °C
INNER GASKET:
 NBR (nitrile rubber), 70 Shore A hardness

| Articolo Code | Filetto Thread size | Diametro cavi Cable clamping range | Chiave Nut | Chiave Nut | |
|------------------|------------------------|---------------------------------------|---------------|---------------|----|
| | EN 60423 | ø mm | L | E | E1 |
| 2812 | M 12 x 1,5 | 4 - 6 | 5 | 14 | 13 |
| 2816 | M 16 x 1,5 | 8 - 10 | 6 | 17 | 15 |
| 2820 | M 20 x 1,5 | 10 - 12 | 7 | 22 | 20 |
| 2825 | M 25 x 1,5 | 17 - 19 | 8,5 | 30 | 28 |
| 2832 | M 32 x 1,5 | 19 - 22 | 9 | 35 | 33 |
| 2840 | M 40 x 1,5 | 26 - 30 | 10,2 | 45 | 42 |
| 2850 | M 50 x 1,5 | 39 - 41 | 10 | 57 | 54 |
| 2863 | M 63 x 1,5 | 43 - 45 | 12 | 64 | 60 |



IP54

PASSO METRICO · ACCESSORI: DADI ESAGONALI
 METRIC THREAD · ACCESSORIES: HEXAGONAL LOCKNUTS

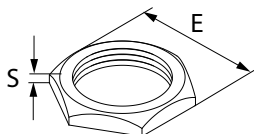

MATERIALE: ottone nichelato
TEMPERATURA D'ESERCIZIO:
 da -40 °C a +100 °C

MATERIAL: nickel-plated brass
OPERATING TEMPERATURE:
 from -40 °C to +100 °C

| Articolo Code | Filetto Thread size | E | S | |
|------------------|------------------------|----|-----|---------|
| | EN 60423 | E | S | |
| 2712 | M 12 x 1,5 | 15 | 2,8 | |
| 2716 | M 16 x 1,5 | 19 | 3 | |
| 2720 | M 20 x 1,5 | 24 | 3,2 | 100/100 |
| 2725 | M 25 x 1,5 | 30 | 3,5 | |
| 2732 | M 32 x 1,5 | 37 | 4 | 50/50 |
| 2740 | M 40 x 1,5 | 46 | 5 | |
| 2750 | M 50 x 1,5 | 60 | 5,5 | 25/25 |
| 2763 | M 63 x 1,5 | 70 | 5,7 | 10/10 |

PASSO METRICO · IP68 · ACCESSORI: TAPPI DI CHIUSURA

METRIC THREAD · IP68 · ACCESSORIES: STOP-ENDS

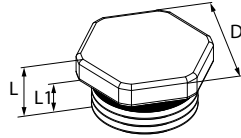

MATERIALE: ottone nichelato
TEMPERATURA D'ESERCIZIO:
 da -40 °C a +100 °C
GUARNIZIONE INTERNA E RONDELLA:
 NBR (gomma nitrilica), durezza 70 Shore A

MATERIAL: nickel-plated brass
OPERATING TEMPERATURE:
 from -40 °C to +100 °C
INNER GASKET AND WASHER:
 NBR (nitrile rubber), 70 Shore A hardness

| Articolo Code | Filetto Thread size | Chiave Nut | Chiave Nut | | |
|------------------|------------------------|---------------|---------------|----|----------|
| | EN 60423 | E | L | L1 | |
| 2612 | M 12 x 1,5 | 14 | 8 | 5 | 100/3500 |
| 2616 | M 16 x 1,5 | 18 | 9 | 6 | 100/2500 |
| 2620 | M 20 x 1,5 | 22 | 10 | 7 | 100/1200 |
| 2625 | M 25 x 1,5 | 28 | 10 | 7 | 100/800 |
| 2632 | M 32 x 1,5 | 36 | 12 | 8 | 100/400 |
| 2640 | M 40 x 1,5 | 45 | 14 | 9 | 100/300 |
| 2650 | M 50 x 1,5 | 55 | 15 | 9 | 50/150 |
| 2663 | M 63 x 1,5 | 70 | 16 | 10 | 50/100 |

IP68

PASSO PG PG THREAD

PASSO PG · IP68 · STANDARD

PG THREAD · IP68 · STANDARD

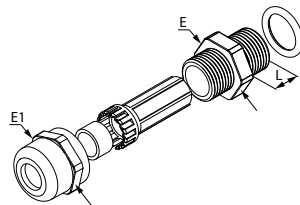

MATERIALE: ottone nichelato
TEMPERATURA D'ESERCIZIO:
 da -40 °C a +100 °C
GUARNIZIONE INTERNA E O-RING:
 NBR (gomma nitrilica), durezza 70 Shore A
GABBIA: poliammide (PA6.6)

MATERIAL: nickel-plated brass
OPERATING TEMPERATURE:
 from -40 °C to +100 °C
INNER GASKET AND O-RING:
 NBR (nitrile rubber), 70 Shore A hardness
CAGE: polyamide (PA6.6)

| Articolo Code | Filetto Thread size | Diametro cavi Cable clamping range | Chiave Nut | Chiave Locknut | |
|------------------|------------------------|---------------------------------------|---------------|-------------------|----|
| | DIN 40430 | ∅ mm | L | E | E1 |
| 2507 | PG 7 | 3 - 6,5 | 6 | 14 | 14 |
| 2509 | PG 9 | 4 - 8 | 7 | 18 | 18 |
| 2511 | PG 11 | 5 - 10 | 7 | 20 | 20 |
| 2513 | PG 13,5 | 6 - 12 | 8 | 22 | 22 |
| 2516 | PG 16 | 10 - 14 | 8 | 24 | 24 |
| 2521 | PG 21 | 13 - 18 | 9 | 30 | 30 |
| 2529 | PG 29 | 18 - 25 | 10 | 40 | 40 |
| 2536 | PG 36 | 25 - 32 | 10 | 50 | 50 |
| 2542 | PG 42 | 32 - 38 | 12 | 58 | 58 |
| 2548 | PG 48 | 37 - 44 | 12 | 64 | 64 |

IP68

PASSO PG · IP68 · CON FILETTO LUNGO
 PG THREAD · IP68 · WITH LONG THREAD

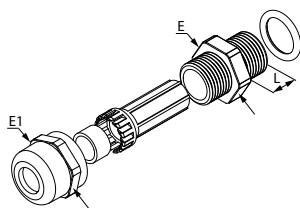

MATERIALE: ottone nichelato
TEMPERATURA D'ESERCIZIO:
 da -40 °C a +100 °C
GUARNIZIONE INTERNA E O-RING:
 NBR (gomma nitrilica), durezza 70 Shore A
GABBIA: poliammide (PA6.6)

MATERIAL: nickel-plated brass
OPERATING TEMPERATURE:
 from -40 °C to +100 °C
INNER GASKET AND O-RING:
 NBR (nitrile rubber), 70 Shore A hardness
CAGE: polyamide (PA6.6)

| Articolo Code | Filetto Thread size | Diametro cavi Cable clamping range | Chiave Nut | Chiave Locknut | |
|------------------|------------------------|---------------------------------------|---------------|-------------------|----|
| | DIN 40430 | ø mm | L | E | E1 |
| 2507L | PG 7 | 3 - 6,5 | 10 | 14 | 14 |
| 2509L | PG 9 | 4 - 8 | 10 | 18 | 18 |
| 2511L | PG 11 | 5 - 10 | 10 | 20 | 20 |
| 2513L | PG 13,5 | 6 - 12 | 10 | 22 | 22 |
| 2516L | PG 16 | 10 - 14 | 10 | 24 | 24 |
| 2521L | PG 21 | 13 - 18 | 12 | 30 | 30 |
| 2529L | PG 29 | 18 - 25 | 12 | 40 | 40 |
| 2536L | PG 36 | 25 - 32 | 15 | 50 | 50 |
| 2542L | PG 42 | 32 - 38 | 15 | 58 | 58 |
| 2548L | PG 48 | 37 - 44 | 15 | 64 | 64 |



IP68

PASSO PG · IP54 · STANDARD
 PG THREAD · IP54 · STANDARD

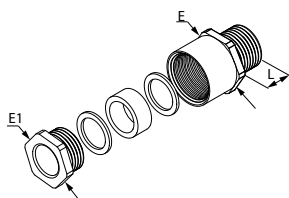

MATERIALE: ottone nichelato
TEMPERATURA D'ESERCIZIO:
 da -20 °C a +70 °C
GUARNIZIONE INTERNA:
 NBR (gomma nitrilica), durezza 70 Shore A

MATERIAL: nickel-plated brass
OPERATING TEMPERATURE:
 from -20 °C to +70 °C
INNER GASKET:
 NBR (nitrile rubber), 70 Shore A hardness

| Articolo Code | Filetto Thread size | Diametro cavi Cable clamping range | Chiave Nut | Chiave Nut | |
|------------------|------------------------|---------------------------------------|---------------|---------------|----|
| | DIN 40430 | ø mm | L | E | E1 |
| 2596 | PG 7 | 4 - 6 | 5 | 14 | 13 |
| 2597 | PG 9 | 8 - 10 | 6 | 17 | 15 |
| 2598 | PG 11 | 8 - 10 | 6 | 20 | 18 |
| 2599 | PG 13,5 | 10 - 12 | 6,5 | 22 | 20 |
| 2600 | PG 16 | 12 - 14 | 6,5 | 24 | 22 |
| 2601 | PG 21 | 17 - 19 | 7 | 30 | 28 |
| 2602 | PG 29 | 26 - 28 | 8 | 40 | 37 |
| 2603 | PG 36 | 33 - 35 | 9 | 50 | 47 |
| 2604 | PG 42 | 39 - 41 | 10 | 57 | 54 |
| 2605 | PG 48 | 43 - 45 | 10 | 64 | 60 |



IP54

PASSO PG · ACCESSORI: DADI ESAGONALI

PG THREAD · ACCESSORIES: HEXAGONAL LOCKNUTS

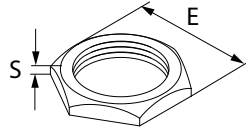

MATERIALE: ottone nichelato
TEMPERATURA D'ESERCIZIO:
 da -40 °C a +100 °C

MATERIAL: nickel-plated brass
OPERATING TEMPERATURE:
 from -40 °C to +100 °C

| Articolo Code | Filetto Thread size | DIN 40430 | | |
|------------------|------------------------|-----------|------|---------|
| | | E | S | |
| 2696 | PG 7 | 15 | 2,8 | |
| 2697 | PG 9 | 18 | 3 | |
| 2698 | PG 11 | 21 | 3 | |
| 2699 | PG 13,5 | 23 | 3 | 100/100 |
| 2700 | PG 16 | 26 | 3,25 | |
| 2701 | PG 21 | 32 | 3,5 | |
| 2702 | PG 29 | 42 | 4 | |
| 2703 | PG 36 | 51 | 5 | 50/50 |
| 2704 | PG 42 | 60 | 5 | 10/10 |
| 2705 | PG 48 | 65 | 5,5 | |

PASSO PG · IP68 · ACCESSORI: TAPPI DI CHIUSURA

PG THREAD · IP68 · ACCESSORIES: STOP-ENDS

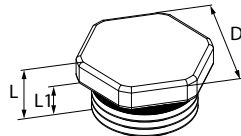

MATERIALE: ottone nichelato
TEMPERATURA D'ESERCIZIO:
 da -40 °C a +100 °C
GUARNIZIONE INTERNA E RONDELLA:
 NBR (gomma nitrilica), durezza 70 Shore A

MATERIAL: nickel-plated brass
OPERATING TEMPERATURE:
 from -40 °C to +100 °C
INNER GASKET AND WASHER:
 NBR (nitrile rubber), 70 Shore A hardness

| Articolo Code | Filetto Thread size | Chiave Nut | Chiave Locknut | | |
|------------------|------------------------|---------------|-------------------|----|----------|
| | | | | | E |
| 2796 | PG7 | 14 | 8 | 5 | 100/3500 |
| 2797 | PG9 | 17 | 9 | 6 | 100/2500 |
| 2798 | PG11 | 20 | 9 | 6 | 100/2000 |
| 2799 | PG13.5 | 22 | 10 | 7 | 100/1200 |
| 2800 | PG16 | 24 | 10 | 7 | 100/1000 |
| 2801 | PG21 | 30 | 11 | 7 | 100/500 |
| 2802 | PG29 | 40 | 12 | 8 | 100/300 |
| 2803 | PG36 | 50 | 15 | 9 | 50/150 |
| 2804 | PG42 | 60 | 16 | 10 | 50/100 |
| 2805 | PG48 | 65 | 16 | 10 | 25/100 |

IP68

PASSO GAS
GAS THREAD

PASSO GAS · IP54 · STANDARD
GAS THREAD · IP54 · STANDARD

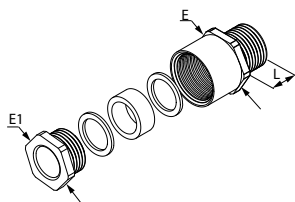

MATERIALE: ottone nichelato
TEMPERATURA D'ESERCIZIO:
da -20 °C a +70 °C
GUARNIZIONE INTERNA:
NBR (gomma nitrilica), durezza 70 Shore A

MATERIAL: nickel-plated brass
OPERATING TEMPERATURE:
from -20 °C to +70 °C
INNER GASKET:
NBR (nitrile rubber), 70 Shore A hardness

| Articolo Code | Filetto Gas Gas thread | Diametro cavi Cable clamping range | Chiave Nut | Chiave Nut | |
|---------------|------------------------|------------------------------------|------------|------------|----|
| | ISO 228/1 | ø mm | L | E | E1 |
| 2450 | G 1/4" | 4 - 6 | 5 | 14 | 13 |
| 2451 | G 3/8" | 8 - 10 | 6 | 17 | 15 |
| 2452 | G 1/2" | 10 - 12 | 7 | 22 | 20 |
| 2453 | G 5/8" | 12 - 14 | 7,5 | 24 | 22 |
| 2454 | G 3/4" | 17 - 19 | 8,5 | 30 | 28 |
| 2455 | G 1" | 19 - 22 | 9 | 35 | 33 |
| 2456 | G 1" 1/8 | 26 - 28 | 10,5 | 40 | 37 |
| 2457 | G 1" 1/4 | 26 - 30 | 10,2 | 45 | 42 |
| 2458 | G 1" 1/2 | 33 - 35 | 12 | 50 | 47 |
| 2459 | G 2" | 43 - 45 | 12 | 64 | 60 |
| 24592 | G 2" 1/2 | 55 - 57 | 12 | 80 | 80 |
| 24593 | G 3" | 67 - 69 | 20 | 95 | 95 |



IP54

PASSO GAS · ACCESSORI: DADI ESAGONALI
GAS THREAD · ACCESSORIES: HEXAGONAL LOCKNUTS

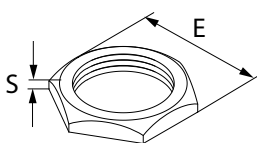

MATERIALE: ottone nichelato
TEMPERATURA D'ESERCIZIO:
da -20 °C a +70 °C

MATERIAL: nickel-plated brass
OPERATING TEMPERATURE:
from -20 °C to +70 °C

| Articolo Code | Filetto Gas Gas thread | E | S | |
|---------------|------------------------|----|------|---------|
| | ISO 228/1 | E | S | |
| 2460 | G 1/4" | 15 | 2,8 | |
| 2461 | G 3/8" | 19 | 3,2 | |
| 2462 | G 1/2" | 24 | 3,75 | 100/100 |
| 2463 | G 5/8" | 26 | 3,75 | |
| 2464 | G 3/4" | 30 | 4 | |
| 2465 | G 1" | 37 | 4,5 | |
| 2466 | G 1" 1/8 | 42 | 5 | 50/50 |
| 2467 | G 1" 1/4 | 46 | 5 | 25/25 |
| 2468 | G 1" 1/2 | 54 | 5,5 | |
| 2469 | G 2" | 65 | 5,7 | 20/20 |
| 24692 | G 2" 1/2 | 80 | 7 | 5/5 |
| 24693 | G 3" | 95 | 8 | 10/10 |

TAPPI DI CHIUSURA IP68

IP68 STOP-ENDS

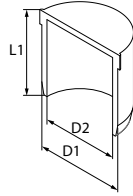

MATERIALE: poliammide
TEMPERATURA D'ESERCIZIO:
 da -40°C a +100°C
COLORE: rosso
COPPIA DI SERRAGGIO: ≥ 1 Nm
CAMPO DI APPLICAZIONE:
 adatto per chiudere il foro di passaggio
 cavo dei pressa cavi IP68 in nylon e ottone
MONTAGGIO:
 Inserire il tappo con le alette di fine corsa in
 battuta sulla guarnizione del pressa
 cavo e serrare

MATERIAL: polyamide
OPERATING TEMPERATURE:
 from -40 °C to +100 °C
COLOR: red
TIGHTENING TORQUE: ≥ 1 Nm
APPLICATIONS:
 Suitable to close IP68 nylon and brass
 cable gland holes
ASSEMBLY:
 Insert the plug with the end-stop wings
 on the cable gland gasket and tighten

| Articolo Code | D1 | D2 | L1 | Metrico - Metric | PG | |
|------------------|----|------|----|------------------|--------|----|
| 4206 | 6 | 2.8 | 16 | M12 | PG7 | 50 |
| | | | | M16 | PG9 | |
| | | | | M20 | PG11 | |
| | | | | | PG13.5 | |
| 4213 | 13 | 8.5 | 22 | M25 | PG16 | 50 |
| | | | | | PG21 | |
| 4220 | 20 | 14.5 | 22 | M32 | PG29 | 25 |
| | | | | M40 | | |
| 4228 | 28 | 22 | 30 | | PG36 | 25 |
| 4238 | 38 | 32 | 35 | M50 | PG42 | 10 |
| | | | | M63 | PG48 | |

IP68