



**HESTORE.HU**

elektronikai alkatrész áruház

**EN:** This Datasheet is presented by the manufacturer.

Please visit our website for pricing and availability at [www.hestore.hu](http://www.hestore.hu).

# INFRARED SENSORS USER'S GUIDE

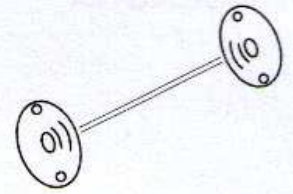

UNIVERSAL INFRARED SENSORS FOR AUTOMATIC DOORS

## TECHNICAL SPECIFICATIONS

GB

TECHNOLOGY	: Infrared
RECEIVER RANGE	: ≤20m
	: Range can be reduced to 30% in bad Weather conditions: fog, rain, dust, etc.
INFRA-RED FREQUENCY	: 1.92Khz
POWER SUPPLY	: 12 to 24V DC/AC
WAVE LENGTH	: 940nm
INPUT	: RX 15mA - TX 30mA
OPERATING TEMPERATURE	: -20°C to 70°C
SENSORS' ANGLE	: <±10°
RELAY OUTPUT	: 1A max 30V
DIMENSIONS	: 49.2 x 76 x 21.6mm

## CONNECTING THE SENSOR

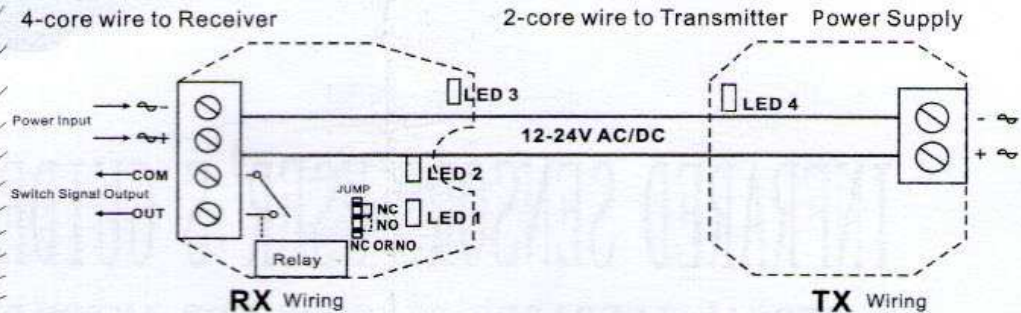

### Installation Note:

Best mounting height less than 20cm, sensor distance not less than 2m. Vertically mounting, level match.  
 Power indicator : LED1,LED4  
 Alarm indicator : LED2  
 Signal indicator : LED3

The Beam signal is strong within 1 meter, for short distance use, please remove the lens to reduce the signal.

## MOUNTING THE SENSOR

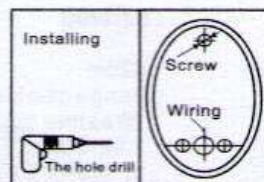

Note: No Inversion avoid Water in

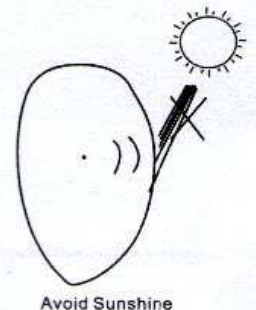
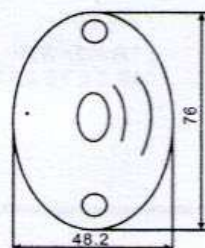

Avoid Sunshine